

Owner's Manual

Snow Tube

WARNING

This is not a lifesaving device.

Do not leave children unattended while device is in use.

Do not tow behind any vehicle.

Do not exceed the manufacturer's recommended number of riders or weight capacity.

Product has no brakes or steering. Do not use near streets, roadways, driveways or sidewalks. Do not use near the proximity of trees or other fixed objects.

Product will gain high speeds under certain snow conditions; Excessive speed can cause loss of control and/or serious injury.

Use of this product involves inherent risk of injury or death.

Do not kneel on product during use.

Do not use in the water as a floating device.

Wearing helmets and safety goggles is strongly recommended.

Do not use on ice or any surface other than snow due to loss of control and maneuverability.

ASSEMBLY

IMPORTANT: For best results, inflate and deflate the snow tube in a warm room.

When the temperature is below 0°C (32°F), the valve can become hard to open.

1. If the snow tube comes with a cloth cover, place the tube into the cover before inflation.

2. Inflation should be done by an adult only. Fill the chambers until most of the wrinkles are gone and the product feels firm to the touch but NOT hard. Do not over-inflate the product. Do not use an air compressor to inflate this product.

Note: Under and over-inflation of the product will result in safety hazards

3. Ensure that all valves are closed before using.

Note: Never stand on or leave objects on the product during inflation. Always check air leakage before using.

INFLATION

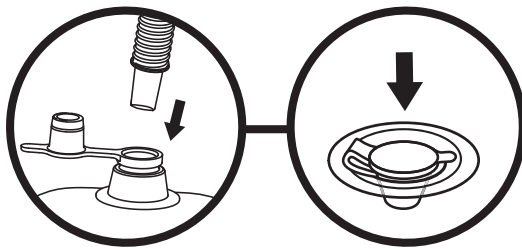

DEFLATION

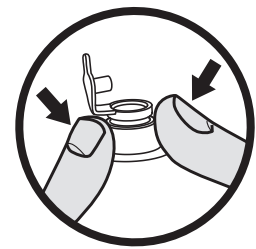

MAINTENANCE AND STORAGE

1. After deflation, use a damp cloth to gently clean all surfaces.

Note: Never use solvents or other chemicals that may damage the product.

2. Store in a cool, dry place and out of children's reach.

3. Check the product for damage at the beginning of each season and at regular intervals when in use.

REPAIR

If a chamber is damaged use the provided repair patch to fix it.

1. Fully deflate the product before repairing it.

2. Fully clean the area to be repaired.

3. Cut the correct size needed from the repair patch material.

4. Apply only the amount of glue needed to cover the repair site. (Glue not included)

5. Press the patch over the area to be repaired.

6. Wait 30 minutes before inflating the product.

Bestway®

©2019 Bestway Inflatables & Material Corp.

All rights reserved/Tous droits réservés/Todos los derechos reservados/Alle Rechte vorbehalten/Tutti i diritti riservati

®™ Trademarks used in some countries under license to/

Marques ®™ utilisées dans certains pays sous la licence de/

Marcas comerciales ®™ utilizadas en algunos países bajo la licencia de/

®™ Die Warenzeichen werden in einigen Ländern verwendet unter Lizenz der/

®™ Marchi utilizzati in alcuni paesi concessi in licenza a

Bestway Inflatables & Material Corp., No.3065 Cao An Road, Shanghai, 201812, China.

Manufactured, distributed and represented in the European Union by/

Fabriqués, distribués et représentés dans l'Union Européenne par/Fabricado, distribuido y representado en la Unión Europea por/

Hergestellt, vertrieben und in der Europäischen Union vertreten von/Prodotto, distribuito e rappresentato nell'Unione Europea da

Bestway (Europe) S.r.l., Via Resistenza, 5, 20098 San Giuliano Milanese (Milano), Italy

Distributed in North America by/Distribués en Amérique du Nord par/Distribuido en Norteamérica por

Bestway (USA) Inc., 3411 E. Harbour Drive, Phoenix, Arizona 85034, United States of America

Tel: +86 21 69135588 (For U.S. and Canada)

Distributed in Latin America by/Distribués en Amérique latine par/Distribuido en Latinoamérica por/Distribuido en América Latina por

Bestway Central & South America Ltda, Salar Ascotan 1282, Parque Enea, Pudahuel, Santiago, Chile

Distributed in Australia & New Zealand by **Bestway Australia Pty Ltd, 98-104 Carnarvon Street, Silverwater, NSW 2128, Australia**

Tel: Australia: (+61) 29 0371 388; New Zealand: 0800 142 101

Exported by/Exporté par/Exportado por/Exportiert von/Esportato da

Bestway (Hong Kong) International Ltd./Bestway Enterprise Company Limited

Suite 713, 7/Floor, East Wing, Tsim Sha Tsui Centre, 66 Mody Road, Kowloon, Hong Kong

www.bestwaycorp.com

Made in China/Fabriqués en Chine/Fabricado en China/Hergestellt in China/Prodotto in Cina