

Bestway®

www.bestwayusa.com

©2022 Bestway Inflatables & Material Corp.

All rights reserved

Trademarks used in some countries under license from Bestway Inflatables & Material Corp., Shanghai, China

Exported by Bestway (Hong Kong) International Ltd./Bestway Enterprise Company Limited

Suite 713, 7/Floor, East Wing, Tsim Sha Tsui Centre, 66 Mody Road, Kowloon, Hong Kong

Distributed in North America by Bestway (USA) Inc., 3435 S. McQueen Road, Chandler, AZ 85286, United States of America

Tel: +86 21 69135588

www.bestwayusa.com

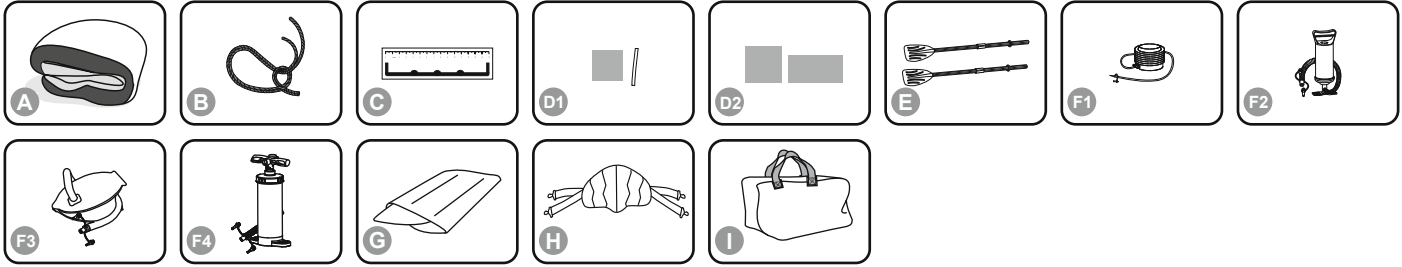

	A	B	C	D1	D2	E	F1	F2	F3	F4	G	H	I
61110E	x1	x1	x1	x1	x0	x1	x0	x0	x1	x0	x0	x0	x0
61068E	x1	x1	x1	x1	x0	x1	x0	x0	x1	x0	x0	x0	x0
65146E	x1	x1	x1	x0	x1	x0	x0	x0	x0	x1	x1	x1	x1
65159E	x1	x1	x1	x1	x0	x1	x0	x0	x0	x1	x0	x0	x1
65164E/65156E/65163E	x1	x1	x1	x1	x0	x1	x0	x1	x0	x0	x0	x0	x1

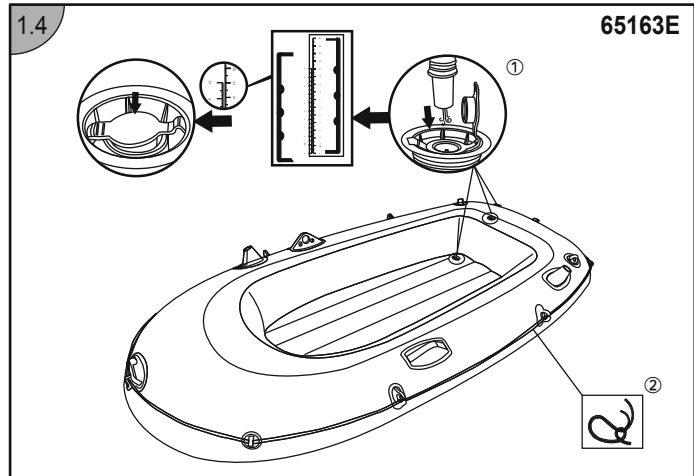
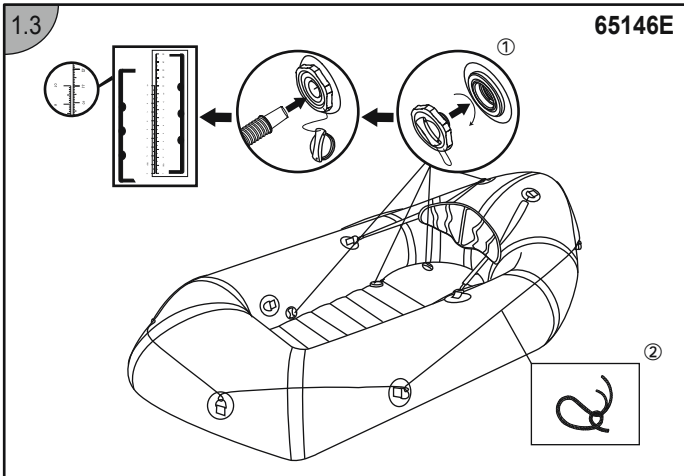
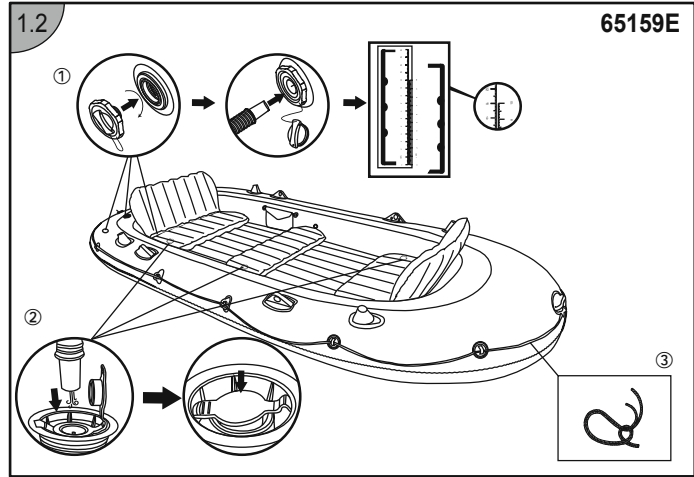
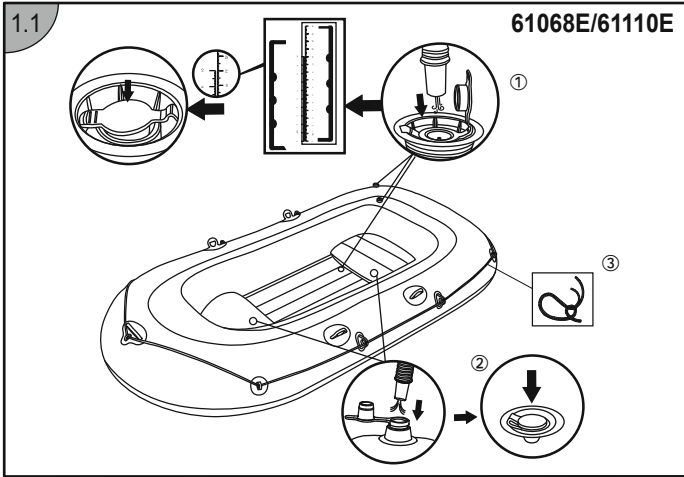

1.5

65156E/65164E

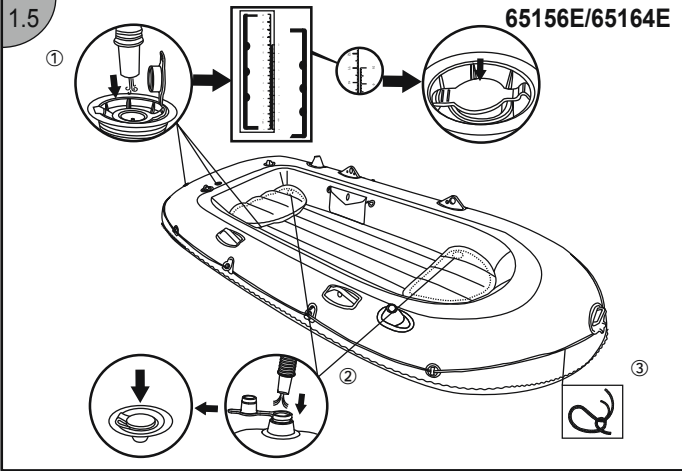

2.1

61068E/61110E/65163E

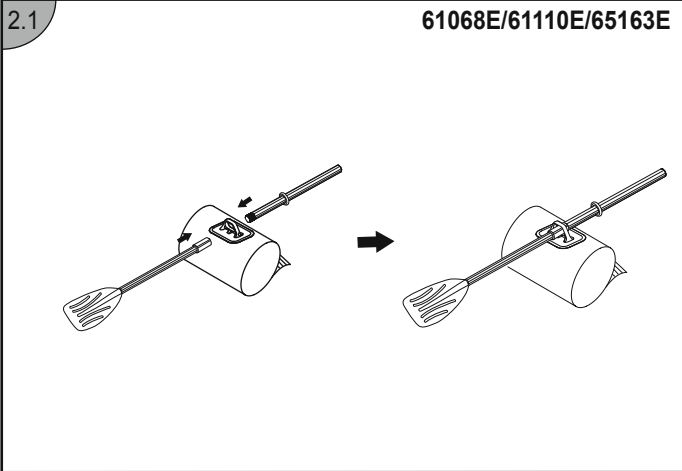

2.2

65156E/65159E/65164E

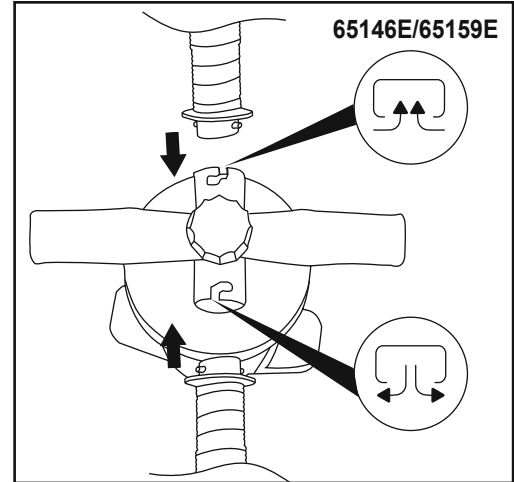
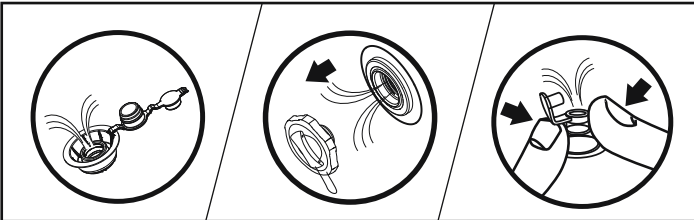
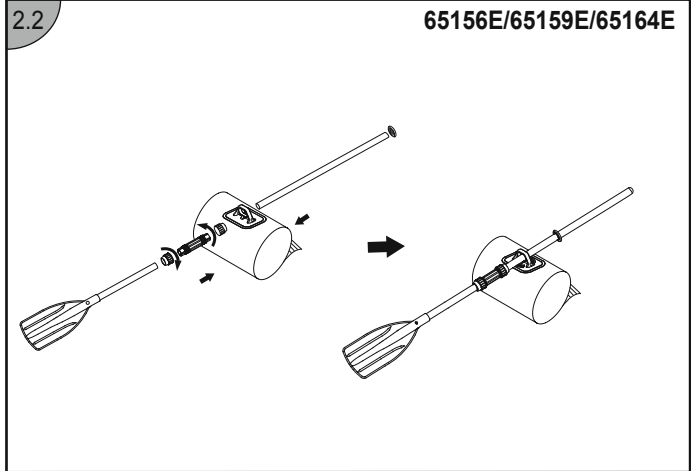

OWNER'S MANUAL

IMPORTANT SAFETY INSTRUCTIONS

Follow all the Safety and Operating Instructions. If you don't follow these instructions, it may cause the boat to overturn or explode and result in drowning.

⚠ WARNING

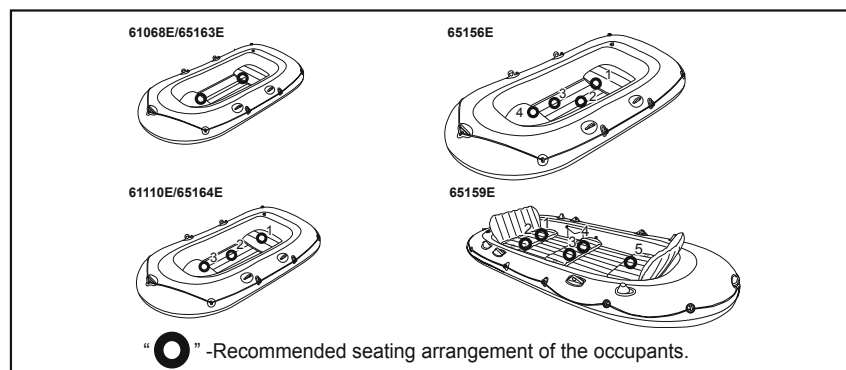

- The boats are designed and manufactured in conformity with ABYC H-28 or ABYC H-29 (only for Kayak).
- To avoid damage to the boat and injury to passengers, please don't exceed the data given on the builder's plate.
- When using the boat, life saving devices such as life jackets and buoys should be pre-inspected and used at all times.
- Before every use, carefully inspect all boat components including air-chambers, grab ropes, oars, and air valves, to ensure everything is in good condition and tightly secured. If you find any damage, please stop to repair it.
- Buckets, water scoops and air pumps should always be available in case of air leakage or if the boat takes on water.
- When the boat is in motion, all passengers must remain seated at all times to avoid falling overboard. Keep the boat balanced. Uneven distribution of persons or load in the boat may cause the boat to overturn and result in drowning.
- If one chamber is punctured when the boat is in the water, it may be necessary to fully inflate the other air chamber to prevent the boat from sinking.
- Be careful when landing on the shore. Sharp and rough objects such as rocks, cement, shells, glass, etc. may puncture the boat. To avoid damage, do not drag the boat on rough surfaces.
- If you accidentally fall overboard, grab the safety rope around the boat and climb aboard.
- Be aware of the potential harmful effects of liquids such as battery acid, oil or petrol. The liquids may damage your boat.
- Inflate according to the numbered air chamber and rated pressure of the boat, or it will cause over-inflation and potential boat explosion. Exceeding the data given on the capacity plate may cause the craft to be damaged, overturn and lead to drowning.
- Know how to operate a boat. Check in your local area for information and/or training as needed. Inform yourself about local regulations and dangers related to boating and/or other water activities.
- The operator of a vessel is responsible for the maintenance and safe conduct of the vessel and the safety of passengers.
- Product misuse is prohibited, such as, but not limited to: (a) riding backwards, gunwale, or in any other unsafe position, (b) failure to use handhold, (c) overloading or improper loading, (d) excessive speed for the operating conditions, (e) using a boat in weather or sea conditions beyond the skill or experience of the operator, (f) continued operation with operator's visibility blocked or impaired (g) operating under the influence of drugs or alcohol, and/or (h) modifications.
- Boat operation where the boat operator or occupants are not under the influence of drugs and/or alcohol.
- Knowledge of federal, state, and/or local regulations concerning operation requirement, including: (a) discharge of oil, (b) solid waste disposal (Marpol Treaty), (c) marine sanitation, (d) speed, (e) noise, and (f) wake
- Knowledge of accident reporting requirements.
- The owner or operator of a vessel is required by law to render assistance to any individual or vessel in distress, as long as his vessel is not endangered in the process.
- When choosing an outboard motor, refer to the technical specifications section of this manual to determine acceptable horsepower ratings.
- For electrical motors equipped with batteries, note that battery acid can be caustic, which can cause damage to both skin and boat materials.
- For motors which use fuels such as gas, oil or petrol, since fuel is a flammable substance, it should be kept away from open flames. Further, clean the boat material immediately if fuel spatters onto the boat surface. Be aware of the potential harmful effects of liquids such as battery acid, oil or petrol. The liquids may damage your boat.
- If you need to register your boat, please have the boat Hull Identification Number and model name ready and then visit bestwayusa.com/support to obtain your Certificate of Origin, or you can send e-mail to service@bestwayusa.com for the Certificate of Origin.
- The HIN is located on the starboard outboard side of the hull and near the stern.

TECHNICAL SAFETY INSTRUCTIONS

- Do not exceed the maximum recommended number of people. Regardless of the number of people on board, the total weight of people and equipment must never exceed the maximum recommended load. Always use the seats/seating spaces provided.
- When loading the craft, never exceed the maximum recommended load. Always load the craft carefully and distribute loads appropriately to maintain design trim (approximately level). Avoid placing heavy weights high up.
- The maximum recommended load includes the weight of all people on board, all provisions and personal effects, any equipment not included in the light craft mass, cargo (if any) and all consumable liquids (water, fuel, etc.).
- Use the craft in sheltered water, up to 300 m (984 feet). Be careful with natural factors such as wind, tide waters and tidal waves. Be aware of offshore winds and currents.
- If you use the tow rings to tow the boat, go slowly to avoid over-towing as damage may occur.
- The boat is intended for beach use, short-time and short-distance cruising.
- U.S. Coast Guard Info line: (800)368-5647. Web site: www.uscgboating.org
- Drawings for illustration purpose only. May not reflect actual product. Not to scale.

SAVE THESE INSTRUCTIONS

TECHNICAL SPECIFICATIONS

Item	Inflated Size	Maximum Weight	Passenger Capacity	Inflation Pressure	Maximum Motor Power	Dry Weight
61068E	8ft.4in. x 50in. (2.55m x 1.27m)	495pounds (225kg)	2 adults	0.03bar (0.5psi)	/	18.8 lbs (8.5kg)
61110E	10ft.1in. x 50in. (3.07m x 1.26m)	594pounds (270kg)	3 adults	0.03bar (0.5psi)	/	21.0 lbs (9.5kg)
65146E	6ft.10in. x 40in. (2.10m x 1.01m)	308 lbs (140kg)	1 adult	0.14bar (2.0psi) / 0.10bar (1.5psi)	/	20.3 lbs (9.2 kg)
65159E	11ft.11in. x 65in. (3.64m x 1.66m)	1323 lbs (600kg)	5 adults	0.07bar (1psi) / 0.05bar (0.7psi)	1.4 hp (1.0 kW)	55.0 lbs (24.7 kg)
65163E	7ft.7in. x 46in. (2.32m x 1.18m)	529 lbs (240kg)	2 adults	0.03bar (0.5psi)	1.4 hp (1.0 kW)	14.8 lbs (6.7 kg)
65164E	9ft.8in. x 54in. (2.94m x 1.37m)	793 lbs (360kg)	3 adults	0.03bar (0.5psi)	1.4 hp (1.0 kW)	25.2 lbs (11.4 kg)
65156E	11ft.6in. x 57in. (3.50m x 1.45m)	1058 lbs (480kg)	4 adults	0.03bar (0.5psi)	1.4 hp (1.0 kW)	30.5 lbs (13.8 kg)

INFLATE & ASSEMBLE

NEVER USE HIGH PRESSURE AIR TO INFLATE INFLATABLES. THIS CAN DAMAGE YOUR PRODUCT.

- Inflate only as far as after inflating one can see some folding at the welding seams. After inflation compare the height of the printed scale on the product with the following table to make sure reach the height of each chamber is reached. Inflate bottom chamber and other accessories such as seat (if included) until it is stiff to the touch but not hard. **DO NOT OVER INFLATE.**
- Take care that the boat has gotten to the correct pressure. Pay attention to both pressure scales on the type-plate and check the pressure from time to time, because in the sun the pressure can grow and it must be balanced then to the correct one.
- Extended exposure to sun can shorten the lifespan of your boat. We suggest to not leave boats in direct sunlight for more than 1 hour after use.
- When the oars (if included) are not in use, lock the oars into the oar clasps to avoid damage.

Item	Product Inflated Size	Printed Scale				
		Deflated Size	Inflated Size Chamber 1	Inflated Size Chamber 2	Inflated Size Chamber 3	Inflated Size Chamber 4
61068E	8ft.4in. x 50in. (2.55m x 1.27m)	5cm / 10cm	5.4cm		11.1cm	/
61110E	10ft.1in. x 50in. (3.07m x 1.26m)	5cm / 10cm	5.4cm	5.4cm	11.3cm	/
65146E	6ft.10in. x 40in. (2.10m x 1.01m)	5cm / 10cm	10.7cm	10.3cm	5.1cm	5.1cm
65159E	11ft.11in. x 65in. (3.64m x 1.66m)	5cm / 10cm	5.4cm	5.6cm	11.5cm	/
65163E	7ft.7in. x 46in. (2.32m x 1.18m)	5cm / 10cm	5.4cm	5.4cm	13cm	/
65164E	9ft.8in. x 54in. (2.94m x 1.37m)	5cm / 10cm	5.4cm	5.4cm	11.8cm	/
65156E	11ft.6in. x 57in. (3.5m x 1.45m)	5cm / 10cm	5.4cm	5.6cm	11.8cm	/

SAFETY ROPE

- Please carefully check whether safety rope is in perfect condition and fastened tightly prior to each use.

STORAGE

- Remove the oars (if included) from the oarlocks. Keep all accessories for future use.
- Carefully clean the boat using a mild soap with clean water. Do not use acetone, acid, and/or alkaline solutions.
- Use a cloth to gently dry all surfaces. The product can be dry under direct sunlight for not more than 1 hour, extended exposure to sun can shorten the lifespan of the boat.
- Deflate the hull chambers. Deflate all the hull chambers at the same time so the air-pressure drops simultaneously.
- This will prevent damage from occurring to the boat's inner structures. Next, deflate the floor.
- Fold the boat from front to back to remove additional air. You can also use a pump to drain any remaining air.

REPAIR

- If there is a small puncture, repair it according to the instructions on the repair patch.
- If the hole is too big to be repaired with the provided patch, purchase a Bestway repair kit or send the boat to a specialty shop to make the repair.

PLEASE KEEP THIS MANUAL IN A SECURE PLACE, AND HAND IT OVER TO THE NEW OWNER WHEN YOU SELL THE CRAFT.