

Bestway[®]

P3150

www.bestwayusa.com

OWNER'S MANUAL

Built-in Sidewinder™ AC Electric Pump

IMPORTANT SAFETY INSTRUCTIONS

READ AND FOLLOW ALL INSTRUCTIONS.

Carefully read, understand, and follow all information in this user manual before installing and using the air mattress.

These warnings, instructions, and safety guidelines address some common risks, but they cannot cover all risks and dangers in all cases. Always use caution, common sense, and good judgement when enjoying the air mattress. Retain this information for future use. In addition, the following information can be supplied depending on the air mattress type.

Safekeeping the instruction. If instruction is missing, search it on the website.

www.bestwayusa.com

FOR INDOOR USE ONLY.

HOUSEHOLD USE ONLY.

WARNING

WARNING



Babies Can Suffocate

To prevent suffocation and death, never place a baby 15 months old or younger on this product.

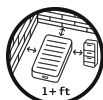

Child Entrapment Hazard

Always position product 1 ft (30 cm) or more away from objects such as walls and dressers to prevent a child from being entrapped.

Keep product fully inflated when in use. See instructions for any additional warnings.

- This appliance has a polarized plug (one blade is wider than the other). To reduce the risk of electric shock, this plug is intended to fit in a polarized outlet only one way, if the plug does not fit fully in the outlet, reverse the plug, if it still does not fit, contact a qualified electrician. Do not attempt to defeat this safety feature.
- Motor run time should not exceed 5 minutes. Operator should allow motor to cool for 5 minutes between uses.
- Product must be stored in a dry location.

TECHNICAL INSTRUCTIONS

**DUAL FUNCTION: INFLATION & DEFLATION EXCLUSIVELY DESIGNED FOR AIR BEDS.
READ CAREFULLY BEFORE OPERATING AND SAVE THESE INSTRUCTIONS.**

TO AVOID THE RISK OF ELECTRIC SHOCK, DO NOT EXPOSE TO WATER OR RAIN.

- Unplug or disconnect the appliance from the power supply before using and servicing.
- The air vent on the cover should be kept free of debris during use.
- Product must be stored in a dry location.
- After use, airbeds may require additional air to increase firmness. Add air to proper firmness.
- This product is not intended for commercial use.
- Drawings for illustration purpose only. May not reflect actual product. Not to scale.

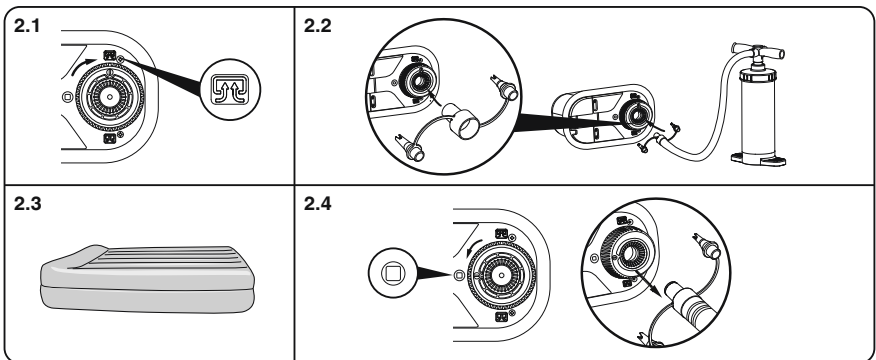
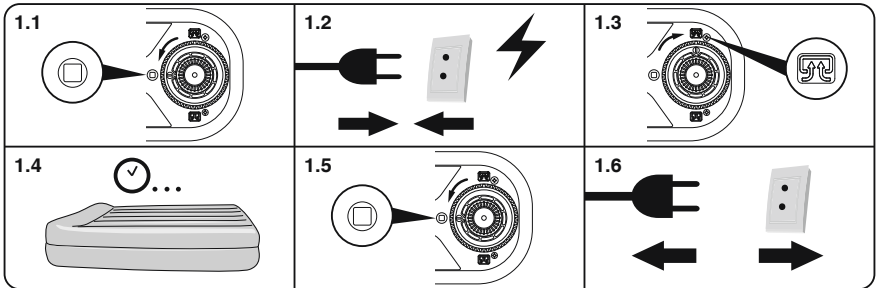
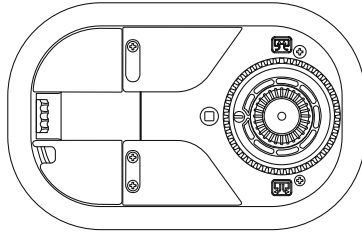



3.1

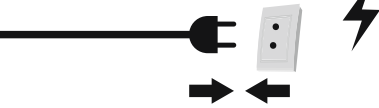

3.2

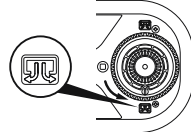

3.3



3.4

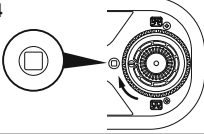

3.5



4.1

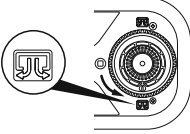

4.2

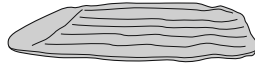

5.1

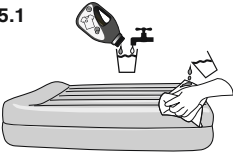

5.2

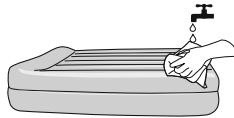

5.3

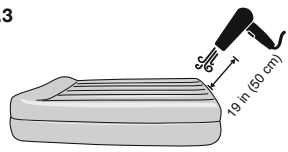

59°F

6.1

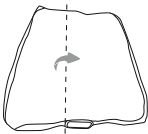

6.2



6.3



6.4

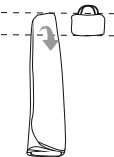

6.5



6.6



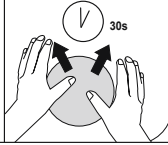
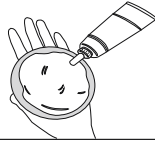
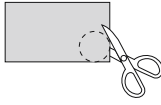
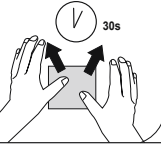
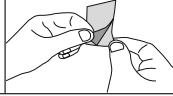

Bestway®

©2023 Bestway Inflatables & Material Corp.

All rights reserved

Trademarks used in some countries under license from **Bestway Inflatables & Material Corp., Shanghai, China**

Exported by **Bestway (Hong Kong) International Ltd./Bestway Enterprise Company Limited**

Suite 713, 7/Floor, East Wing, Tsim Sha Tsui Centre, 66 Mody Road, Kowloon, Hong Kong

Distributed in North America by **Bestway (USA) Inc., 3435 S. McQueen Road, Chandler, AZ 85286, United States of America**

Tel: +86 21 69135588

www.bestwayusa.com