

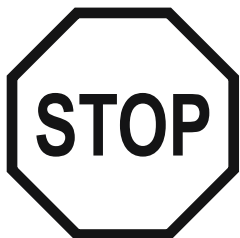

POWER STEEL™

OWNER'S MANUAL

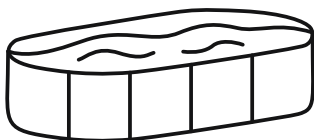

**DO NOT RETURN THIS ITEM TO
THE STORE OR WEBSITE WHERE
IT WAS PURCHASED.**

**PLEASE VISIT
[BESTWAYUSA.COM/SUPPORT](https://www.bestwayusa.com/support)
FOR QUESTIONS, PROBLEMS,
OR WARRANTY CLAIMS.**

TABLE OF CONTENTS

SAFETY INFORMATION

PAGE 3

- Carefully read over the important safety instructions and warnings before operating and keep this manual for future reference. Failure to follow safety information can result in serious injury or death to users.

ADDENDUM

PAGE 4

- Your pool location and surroundings should comply with the "Safety Barrier Guidelines for Residential Swimming Pools".

PARTS & TOOLS NEEDED

PAGE 6

- To check the parts included in the box, consult the part list inside this manual. Verify that the equipment components represent the model that you had intended to purchase.
- In case of any damaged or missing parts at the time of purchase, visit our website bestwayusa.com/support.

SETUP INSTRUCTIONS

PAGE 7

- For the installation instructions, refer to the illustration steps  inside the manual. Drawings are for illustration purposes only. May not reflect actual product. Not to scale.
- Bestway will not be responsible for any damage caused to the pool due to mishandling or failure to follow these instructions.

MAINTENANCE INSTRUCTIONS

PAGE 10

- Chemical maintenance must be performed for the health of your pool. Not adhering to the guidelines in this section might put you and your family's health at risk.

DISASSEMBLY & STORAGE INSTRUCTIONS

PAGE 11

- Be sure that your pool is completely clean and dry before storage. If all the parts are not completely dry, mold may result.
- Store in a dry place with a moderate temperature between 59°F / 15°C and 100°F / 38°C.

WARRANTY TERMS

PAGE 11

- For information concerning warranty terms, visit our website at: www.bestwayusa.com.

SAFETY INFORMATION

WARNING

Save these instructions – Read and Follow All Safety Information and Instructions.

Keep for future reference. Failure to follow these warnings and instructions can result in serious injury or death to users, especially children.

⚠ WARNING

Prevent Drowning



Children under 5 are at highest risk for drowning. Closely watch children who are in or near this pool.

⚠ WARNING

No Diving



You can break your neck and be paralyzed!

⚠ WARNING

Electrocution Risk



Keep all electrical lines, radios, speakers, and other electrical devices away from the pool. Do not place the pool near or under overhead electrical lines.

⚠ WARNING

Stay away from drains & suction fittings



If drain or suction outlet cover is missing or broken, your hair, body, and jewelry can get sucked into drain. You could be held under water & drown! Do not use pool if drain or suction outlet cover is missing or broken.

Prevent Young Children from Gaining Access to the Pool & Drowning:

Check state or local laws and codes before setting up the pool. Drowning occurs silently and quickly. Assign an adult to supervise pool and wear a "water watcher" sticker. If they need to leave for any reason, ask this person to pass the "water watcher" sticker and the supervision responsibility to another adult.

Install fencing or an approved barrier around all sides of the pool. Refer to the list of barrier recommendations and guidelines as described in CPSC Publication No. 362. (See addendum inside the manual for more regulation information.)

Keep children in your direct sight when they are in or near the pool and when you are filling or emptying the pool. Do not remove any safety barriers until the pool is completely empty and stowed away.

Place filter pumps and other accessories so that children cannot climb on them to gain access to the pool.

Remove pool ladders before leaving the pool. Toddlers can climb ladder and get into pool.

Position furniture away from the pool so that children cannot climb on it to gain access to the pool.

When leaving the pool, remove all floats and toys from the pool that might attract a child.

When searching for a missing child, check the pool first, even if you think your child is in the house.

Be Prepared to Respond to an Emergency:

Keep a working phone and list of emergency numbers near pool. Become certified in cardiopulmonary resuscitation (CPR) so you can respond to an emergency.

Accessory Replacements:

A replacement filter pump should never exceed the maximum flow rate marked on the suction fitting.

If your purchased pool set does not have a filtration system, you can purchase it separately. Please make sure the equipment can turn over a total volume of pool water no less than once every 12 hours. You can check the water capacity on the packaging of your selected filtration system. The pump must be tested by a nationally recognized testing laboratory and certified to conform to UL1081.

Make sure the selected suction outlet sold with the pump has been tested by a nationally recognized testing laboratory and is certified to conform to ASME/ANSI A112.19.8 or its successor standard ANSI/APSP-16, to prevent suction entrapment.

Additional Information:

This product is compliant to ANSI/APSP 4 American National Standards for above ground and on-ground residential swimming pools and to the International Swimming Pool & Spa Code (ISPS). *Only applies to pools with a water depth of more than 36 in. (91.4 cm) in the USA.

For further safety tips, check out the following websites:

- www.homesafetycouncil.org
- <http://www.safety-council.org/info/child/water.html>
- www.safekids.org
- www.nspi.org

SAFETY BARRIER GUIDELINES FOR RESIDENTIAL SWIMMING POOLS

Section I: Outdoor Swimming Pools

An outdoor swimming pool, including an inground, aboveground, or onground pool, hot tub, or spa, should be provided with a barrier which complies with the following:

- The top of the barrier should be at least 48 inches above grade measured on the side of the barrier which faces away from the swimming pool. The maximum vertical clearance between grade and the bottom of the barrier should be 4 inches measured on the side of the barrier which faces away from the swimming pool. Where the top of the pool structure is above grade, such as an aboveground pool, the barrier may be at ground level, such as the pool structure, or mounted on top of the pool structure. Where the barrier is mounted on top of the pool structure, the maximum vertical clearance between the top of the pool structure and the bottom of the barrier should be 4 inches.
- Openings in the barrier should not allow passage of a 4-inch diameter sphere.
- Solid barriers, which do not have openings, such as a masonry or stone wall, should not contain indentations or protrusions except for normal construction tolerances and tooled masonry joints.
- Where the barrier is composed of horizontal and vertical members and the distance between the tops of the horizontal members is less than 45 inches, the horizontal members should be located on the swimming pool side of the fence. Spacing between vertical members should not exceed 1½ inches in width. Where there are decorative cutouts, spacing within the cutouts should not exceed 1½ inches in width.
- Where the barrier is composed of horizontal and vertical members and the distance between the tops of the horizontal members is 45 inches or more, spacing between vertical members should not exceed 4 inches. Where there are decorative cutouts, spacing within the cutouts should not exceed 1½ inches in width.
- Maximum mesh size for chain link fences should not exceed 1½ inch square unless the fence is provided with slats fastened at the top or the bottom which reduce the openings to no more than 1½ inches.
- Where the barrier is composed of diagonal members, such as a lattice fence, the maximum opening formed by the diagonal members should be no more than 1½ inches.
- Access gates to the pool should comply with Section I, Paragraphs 1 through 7, and should be equipped to accommodate a locking device. Pedestrian access gates should open outward, away from the pool, and should be self-closing and have a self-latching device. Gates other than pedestrian access gates should have a self-latching device. Where the release mechanism of the self-latching device is located less than 54 inches from the bottom of the gate, (a) the release mechanism should be located on the pool side of the gate at least 3 inches below the top of the gate and (b) the gate and barrier should have no opening greater than ½ inch within 18 inches of the release mechanism.
- Where a wall of a dwelling serves as part of the barrier, one of the following should apply:
 - All doors with direct access to the pool through that wall should be equipped with an alarm which produces an audible warning when the door and its screen, if present, are opened. The alarm should sound continuously for a minimum of 30 seconds within 7 seconds after the door is opened. Alarms should meet the requirements of UL2017 General-Purpose Signaling Devices and Systems, Section 77. The alarm should have a minimum sound pressure rating of 85 dBA at 10 feet and the sound of the alarm should be distinctive from other household sounds, such as smoke alarms, telephones, and door bells. The alarm should automatically reset under all conditions. The alarm should be equipped with manual means, such as touchpads or switches, to temporarily deactivate the alarm for a single opening of the door from either direction. Such deactivation should last for no more than 15 seconds. The deactivation touchpads or switches should be located at least 54 inches above the threshold of the door.
 - The pool should be equipped with a power safety cover which complies with ASTM F1346-91 listed below.
 - Other means of protection, such as self-closing doors with self-latching devices, are acceptable so long as the degree of protection afforded is not less than the protection afforded by (a) or (b) described above.
- Where an above ground pool structure is used as a barrier or where the barrier is mounted on top of the pool structure, and the means of access is a ladder or steps, then (a) the ladder to the pool or steps should be capable of being secured, locked or removed to prevent access, or (b) the ladder or steps should be surrounded by a barrier which meets Section I, Paragraphs 1 through 9. When the ladder or steps are secured, locked, or removed, any opening created should not allow the passage of a 4-inch diameter sphere.

Section II: Barrier Locations

Barriers should be located so as to prohibit permanent structures, equipment or similar objects from being used to climb the barriers.

- Only for outdoor use.
- Teach your children to swim.
- Never dive, jump, or slide into the pool.
- Adult supervision is always required.
- Parents should learn CPR.
- Never swim alone.
- Keep all electrical radios, speakers and other appliances away from the swimming pool.
- When you touch the filter, pump, or electrical parts, be sure the ground under your feet is "Bone Dry".
- All electrical outlets should have a GFCI and connections should be a minimum of 5 feet (1.52 m) from the outside perimeter of the wall of the pool. From 5-10 feet (1.52-3.05 m), there should be either a fixed connection (outlet box) or twistlock connection with a GFCI.
- Connect power cords to a 3-wire grounding-type outlet only.
- Keep all breakable objects out of the pool area.
- Alcohol consumption and pool activities do not mix. Never allow anyone to swim, dive or slide under the influence of alcohol or drugs.
- Severe electrical shock could result if you install your pump or filter on a deck. The pump or filter could fall into the water, causing severe shock or electrocution. Do not install on a deck or other surface at, above, or slightly below the top rail of the pool.
- Do not use the pool during severe weather conditions, i.e. electrical storms, tornadoes, etc.
- Be aware of overhead power lines when vacuuming your pool or using a telescoping pole.
- Do not allow diving, climbing, sitting, or standing on the top rails of the pools.
- Do not allow roughhousing and horseplay.
- Do not engage in extended breath holding activities underwater; you may black out and drown.
- Install a pool ladder(s) or staircase for entry and exit from the pool.
- Keep deck clean and clear of objects that may create a tripping hazard.
- Check regularly for signs of wear or loose bolts that could make the deck unsafe.

SAFETY BARRIER GUIDELINES FOR RESIDENTIAL SWIMMING POOLS

- Instruct pool users about the proper use of all pool ladder(s) and staircases.
- Face ladder going up or down.
- Allow only one person at a time on the ladder.
- Check all nuts and bolts regularly to ensure that the ladder stays sturdy.
- Remove or secure the ladder to prevent entry to pool when not in use.
- Please contact pool site dealer or manufacturer for additional safety signs if deemed necessary.
- For pool service, select a certified pool professional.
- Any equipment connected to the circulation systems shall be positioned so as to prevent their being used as a means of access to the pool by young children.
- The installation must comply with the codes of the authority having jurisdiction and may require permits for building, plumbing electrical, zoning, etc.
- The pool shall be located a minimum distance of 6 ft. (1.83 m) from any electrical receptacle.
- All 125 volt, 15 and 20 ampere receptacles located within 20 ft. (6 m) of the pool shall be protected by a ground fault circuit interrupter (GFCI). The 20 ft. (6 m) distance is measured via the shortest straight-line distance the supply cord would follow without piercing a floor, wall, ceiling, doorway, window or other permanent barrier.
- Prior to use of the pool, the installer shall affix all no diving signs and safety signs in accordance with installation instructions so they can be easily visible.
- A barrier is necessary to provide protection against potential drowning and near drowning and that barriers are not a substitute for the constant supervision of children.
- A list of emergency telephone numbers shall be posted, such as the nearest available police, fire, ambulance, and/or rescue unit. These numbers are to be kept near the telephone that is closest to the pool.
- Toys, chairs, tables or similar objects that a young child could climb shall be at least 4 feet (1.22 m) from the pool.
- If deck is used by the installer, it will need to comply with APSP-8.
- Basic lifesaving equipment, including one of the following, shall be on hand at all times:
 - A light, strong, rigid pole (shepherd's crook) not less than 12 ft. (3.66 m) long.
 - A minimum ¼ in. (6 mm) diameter rope as long as 1½ times the maximum width of the pool or 50 feet (15.24 m), whichever is less, which has been firmly attached to a Coast Guard-approved ring buoy, or a similarly approved flotation device.
- The swimming pool cover is not designated as a safety barrier. Please use artificial lighting during nighttime pool use, to illuminate all safety signs, ladders, steps, deck surfaces and walks.
- The pool is subject to wear and deterioration. If not maintained properly, certain types of excessive or accelerated deterioration can lead to failure of the pool structure that might release large quantities of water that could cause bodily harm and property damage.
- The bottom of the pool shall be visible at all times from the outside perimeter of the pool.
- The installer of the vinyl liner shall affix on the original or replacement liner, or on the pool structure, all safety signs in accordance with the manufacturer's instructions.
- The ladder shall be located on a solid base and the ladder shall be installed per the ladder's instructions.
- Publications are available that describe the risk of drowning, entrapment, and diving accidents. Available publications related to pool safety include the Association of Pool and Spa Professionals' (APSP) booklets entitled: The Sensible Way to Enjoy Your Aboveground/Onground Swimming Pool, Children Aren't Waterproof, Pool and Spa Emergency Procedures for Infants and Children, Layers of Protection, and the latest published edition of ANSI/APSP-8 Model Barrier Code for Residential Swimming Pools, Spas, and Hot Tubs.

For additional safety information, see www.APSP.org.

PARTS & TOOLS NEEDED

Compare the parts in your box to the parts listed in this manual. Verify that the equipment components represent the model that you had intended to purchase. If any parts are damaged or missing at the time of purchase, visit our website bestwayusa.com/support.

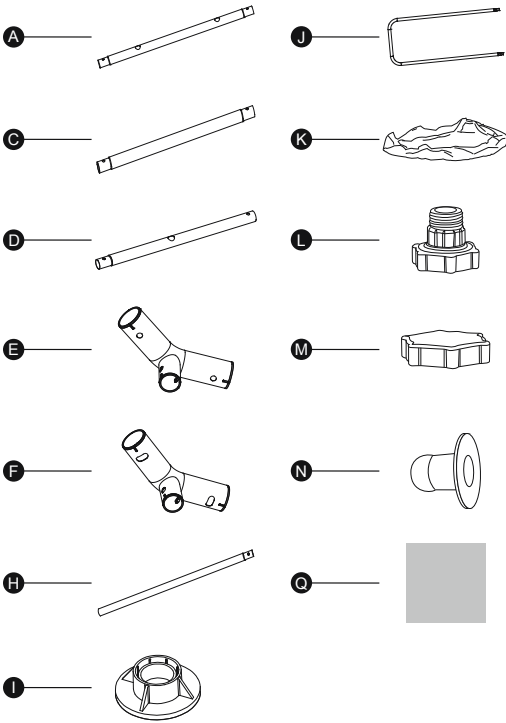

POWER STEEL™	16 ft. x 10 ft. x 42 in. (4.88 m x 3.05 m x 1.07 m)
	90481E
A	x2
C	x8
D	x4
E	x6
F	x4
H	x10
I	x10
J	x4
K	x1
L	x1
M	x1
N	x3
Q	x3

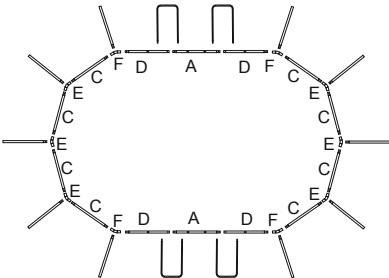

SETUP INSTRUCTIONS

OVERVIEW

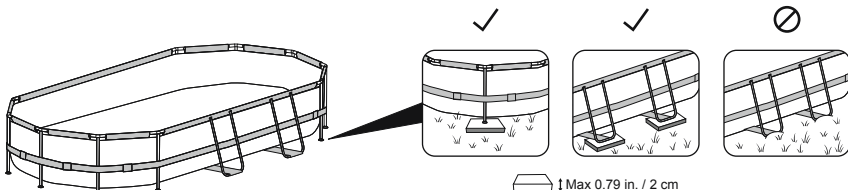
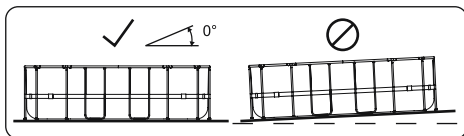

CHOOSING THE CORRECT LOCATION

The location chosen where the pool will be installed must respect the following conditions:

- Because of the combined weight of the water inside the pool and the users, it is extremely important that the surface chosen is capable of uniformly supporting the total weight for the entire time the pool is installed. When choosing the surface, take into consideration that water may come out of the pool when in use or when it rains. If the water softens the surface, it may lose its capability to support the pool weight.
- Check the position of the vertical legs and/or the U-supports regularly. They must always be level with the bottom of the pool. If the vertical leg or the U-support starts to sink into the ground, drain the pool water immediately to avoid the pool collapsing due to the uneven load on the frame structure. Change the location of the pool or modify the surface material.
- The surface must be flat and smooth. If the surface is inclined or uneven, it can create an unbalanced load on the structure of the pool. This can damage the welding points of the liner and bend the frame. In the worst cases, the pool can collapse, causing serious personal injury and/or damage to personal property.
- We recommend positioning the pool away from any objects children could use to climb into the pool.
- Position the pool near an adequate drainage system to deal with overflow or to empty the pool. Ensure the pool side with the **water inlet A and outlet B** is facing in the direction of the power source, where the filtration system will be connected.
- The selected surface must be clear of any type of object. Due to the weight of the water, any object under the pool could damage or perforate the bottom of the pool.
- The selected surface must be clear of aggressive plants and weed species. Types of strong vegetation could grow through the liner and create water leakage. Grass or other vegetation that may cause odor or slime to develop must be eliminated from the chosen location.
- The selected location must not have overhead power lines or trees. Be sure the location does not contain underground utility pipes, lines or cables of any kind.
- The selected position must be far from house entrance. Do not position any equipment or other furniture around the pool. The water that comes out of the pool during use or due to product malfunctions can damage furniture inside the house or surrounding the pool.
- The selected surface must be flat and without holes that can damage the material of the liner.

Suggested surfaces: grass, ground, concrete and all other surfaces that respect the above set-up conditions.

Surfaces to avoid: mud, sand, gravel, deck, balcony, driveway, platform, soft/loose soil or other surface that does not meet the above set-up conditions.

Follow the important instructions above to choose the correct surface and location to set up your pool. If parts become damaged because the set-up surface and location does not adhere to these instructions, it will not be considered a manufacturer defect and will void the warranty and any service claims.

If the selected surface is too soft to hold the frame, install wood or metal plates with a thickness of no bigger than 0.79 in. (2 cm) under the legs. The plates must not touch the liner or have a sharp area, as this can cause damage and will not be covered under the manufacturer's warranty.

Additional Guidelines:

Check with your local city council for bylaws relating to fencing, barriers, lighting and safety requirements, and ensure you comply with all laws.

If a pump and/or ladder is included in the set, refer to the pump's and/or ladder's manual for safety instructions and installation. The ladder must match the pool size.

If you must change locations during set-up, lift the liner to move it; do not drag it on the ground. The friction between the PVC material and the ground can damage the pool liner.

Assembly Instructions

For installation instructions, scan the QR Code printed on the front cover or follow the illustrations below. Drawings are for illustration purposes only. May not reflect actual product. Not to scale.

Assembly of this pool can be completed without additional tools. Installation takes approximately 60 minutes with 2-3 people, excluding any preparations or water filling. Please note that assembly times may vary based on pool size and individual experience.

Bestway is not responsible for damage caused to the pool due to mishandling or failure to follow these instructions.

SETUP INSTRUCTIONS

Helpful Installation Tips:

We strongly suggest opening the package and assembling the pool when the ambient temperature is above 59°F / 15°C. The PVC material of the liner will be more flexible and easier to assemble in this environment.

We suggest you buy a pool ladder (if one is not included in the set) and prepare it before setting up the pool, as it will help whenever you need to get inside it.

Filling the Pool with Water:

ATTENTION: Do not leave the pool unattended while filling with water. Continuously check the pool to ensure it is being filled correctly. Make sure the vertical legs are always perpendicular to the ground and not under the liner or leaning to the side. Ensure that the belt of the U-Support is completely extended.

It is highly recommended to use tap water for filling to minimize unwanted content, such as minerals. Do not use sea water. Fill the pool with water after all assembly steps are completed and until the water reaches the welding line, which corresponds to 90% of the full capacity. Do not overfill as this could cause the pool to collapse. In the case of heavy rainfall, we strongly recommend reducing the water level to keep it at 90% capacity and avoid the overflow of water.

IMPORTANT: When the pool is 90% full, check that the distance between the water surface and the top of the rails is the same all around. If it is different, it means that the surface is not level, and we strongly recommend draining the water and adjusting the chosen location. Never attempt to move the pool with water still in it.

IMPORTANT: Keeping the pool full of water on uneven ground can cause the bursting of welding points and/or pool collapse, causing serious personal injury and/or damage to property. Your pool may contain a great deal of pressure. If your pool has a bulge or uneven side, the sides may burst, suddenly releasing water and causing serious personal injury and/or damage to property. When the pool is 90% full, check the pool for any leaks at the valves or seams and for any evident water loss. Do not add any chemicals to the water until this has been done.



INSTALLATION

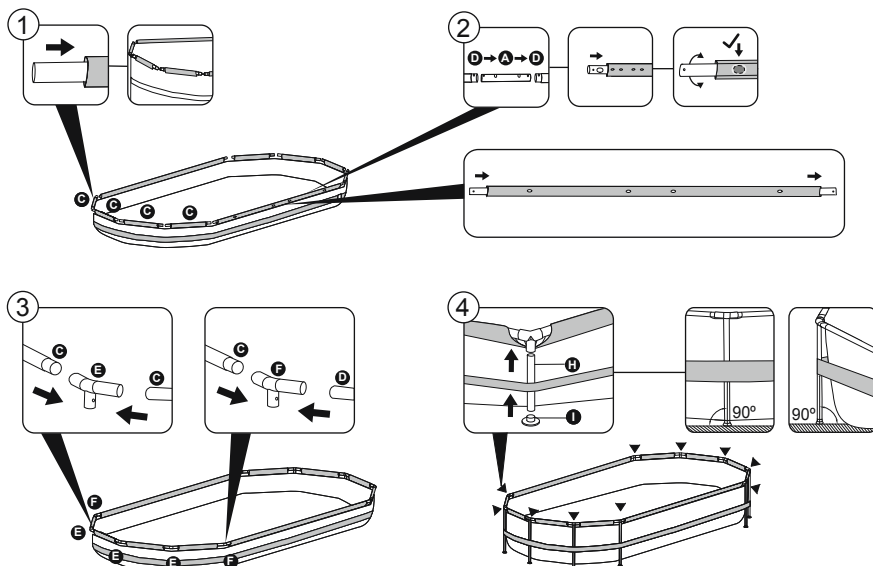

IMPORTANT: The vertical legs must be inserted between the liner and the belt before attaching the T-connectors. The legs must be perpendicular to the ground in two directions.



INSTALLATION

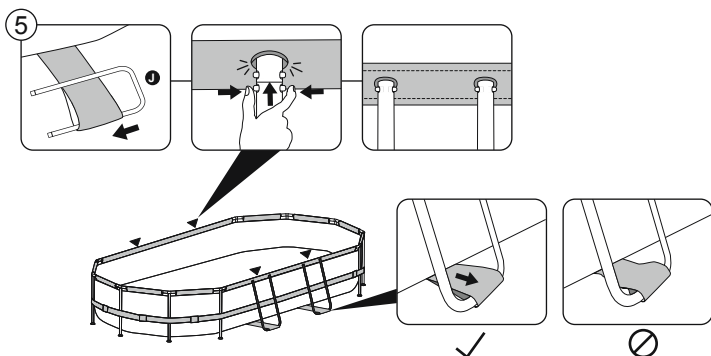

Fully extend the support sleeves on the bottom of the liner to ensure the correct positioning of the U supports.

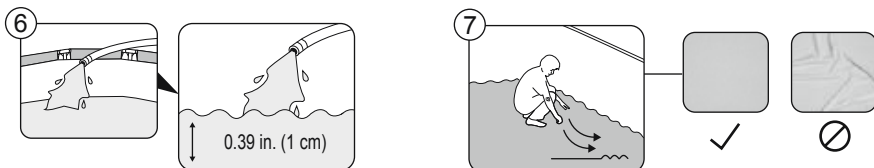

When the pool is filled with around 0.39 in. (1 cm) of water, gently smooth out the bottom liner to remove all folds. We recommend starting from the center of the pool and continuing outwards. You can continue to fill the pool when the floor is smooth and wrinkle-free.

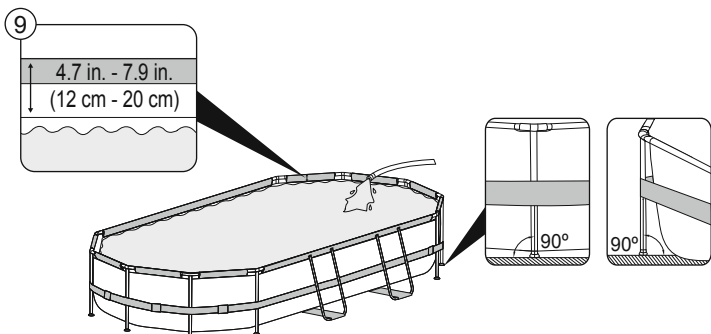
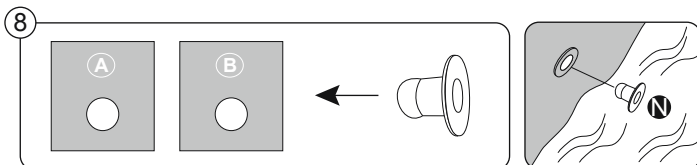

IMPORTANT: Check the position of the vertical legs at times while filling the pool with water. The legs can gradually change position due to increased water weight. If the legs are not perpendicular to the ground, please stop filling the pool and adjust them. It will help with weight distribution to avoid strain on the frame and liner.

MAINTENANCE INSTRUCTIONS

Keeping your pool water clean and chemically balanced is necessary. Simply using the filtration system and cleaning the filter cartridge is not enough for proper maintenance of the water. It is important to prioritize the maintenance and health of your pool water. If you do not adhere to these guidelines, your and your family's health might be at risk.

Water Maintenance:

We recommend you use pool chemicals to maintain water chemistry and chlorine or bromine tablets (do not use granules) with a chemical dispenser.

The chemical maintenance with chemical tablets must be performed with a chemical dispenser or chemical floater. Do not throw chemical products directly into the water. The chemicals will settle on the bottom of the pool and damage and discolor the liner. In the worst cases, it will damage the structure of the pool liner.

Pool damage resulting from the misuse, number of users and overall mismanagement of pool water is not covered by the warranty.

Water quality is directly related to frequency of use, number of users and overall maintenance of the pool. The water should be changed every 3 days if there is no chemical treatment being performed with the water. We recommend that you take a shower before using your pool, as cosmetic products, lotions and other residues on the skin can quickly degrade water quality. Place a bucket of water next to the pool to clean users' feet before they enter the water.

Use a pool skimmer for the surface and a vacuum cleaner for the pool bottom regularly to avoid settled dirt. If they are not included in the set, you can purchase them by visiting our website (www.bestwayusa.com) or by visiting the nearest pool supply store.

Chemical Usage:

Your pool set may not include a chemical dispenser. In this case, you can purchase one by visiting our website (www.bestwayusa.com) or by visiting the nearest pool supply store. Remove the chemical dispenser when the pool is in use. After performing chemical maintenance and before using the pool, use a test kit (not included) to test the water chemistry. We recommend maintaining your water's chemical balance as shown in the table below.

Exceeding the following parameters can damage the structure of the liner and create a dangerous situation for the users.

TEST	IDEAL VALUES
pH value	7.4 – 7.6
Cyanuric acid	30 – 50 ppm
Free chlorine	2 – 4 ppm
Chlorine compound	0
Algae	None visible
Calcium hardness	200 – 400 ppm

Please consult your local pool or chemical supply retailer for more information about chemical maintenance. Pay close attention to the chemical manufacturer's instructions.



POOL COVER

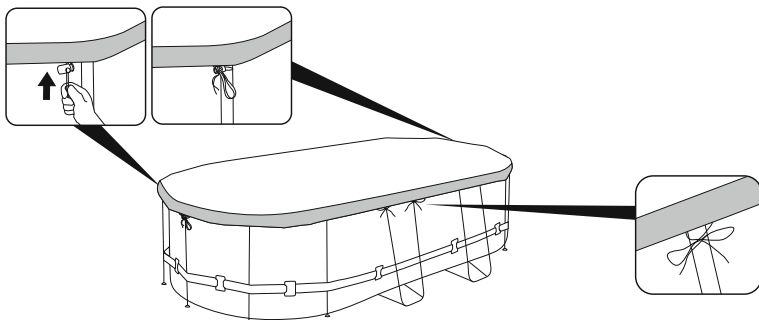

Ongoing Pool Maintenance:

We suggest that you buy a pool cover, if one is not included in the set, and cover the pool when not in use to prevent damage to the top rail material. Gently clean any dirt from the top rails with a clean cloth. In the event of a leak, patch your pool using the underwater adhesive repair patch provided. You can find the instructions in the FAQs on the support section of our website (www.bestwayusa.com/support).

Accessory Attachments

If a pump and/or ladder is included in the set, refer to the pump's and/or ladder's manual for safety instructions and installation. The ladder must match the pool size.

If your pool has a connection valve for attaching pool cleaning accessories, you must remove the debris screen from the connector prior to accessory attachment.

DISASSEMBLY & STORAGE INSTRUCTIONS



DRAINING

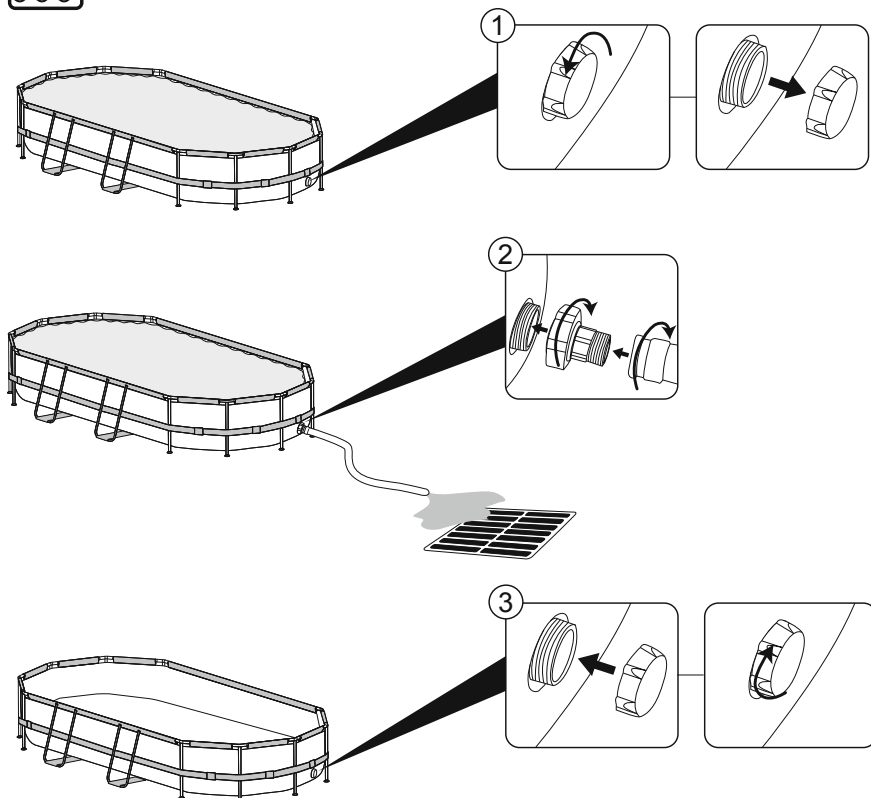

For draining, follow the illustrations. Drawings are for illustration purposes only. May not reflect actual product. Not to scale. Before draining your pool water, make sure that you are draining your pool away from the house and any objects that are subject to water damage. Check local regulations for drainage by laws.

Cleaning:

1. Rinse the pool liner with tap water to remove any residue left by chemicals or debris.
2. Leave the flattened liner in the sunlight until it's completely dry.
3. To remove the remaining water completely, wipe the pool liner with a dry cloth.

Storage:

Remove all accessories. Be sure that pool liner and accessories are completely clean and dry before storage. If the pool is not completely dry, mold may result and will damage the pool liner during the storage period. Once the pool is completely dry, sprinkle with talcum powder to prevent the liner from sticking together. We strongly recommend disassembling the pool when the ambient temperature is above 59°F / 15°C. Fold the pool liner only if the ambient temperature is above 59°F / 15°C. Store the pool in a dry place with a moderate temperature between 59°F / 15°C and 100°F / 38°C and keep the pool liner and all accessories inside a cardboard box to better protect the PVC material during the winter period.

WARRANTY TERMS

For support and product registration, please visit bestwayusa.com/support.

1. Find the broken area.

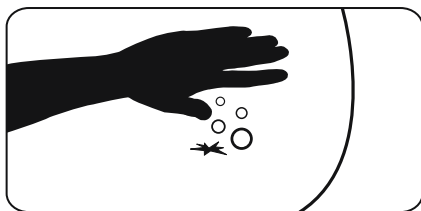

2. Clean the area to be repaired.

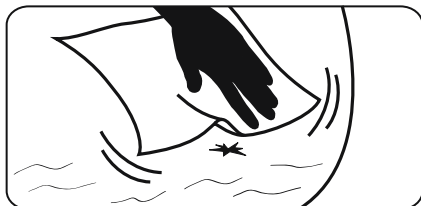

3. Carefully peel patch.

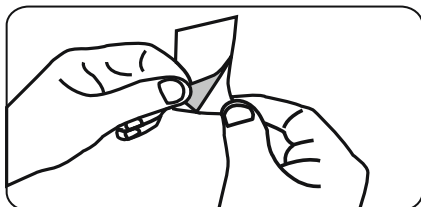

4. Apply the repair patch to repaired site and smooth out any air bubbles. Press for 30 seconds.

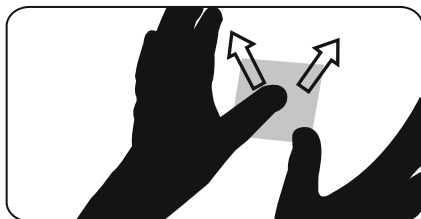

5. Wait 30 minutes before use.



1. Discharge the water, fully clean and dry area to be repaired.



2. Cut the correct size from the Trittech PVC Material Repair Patch.

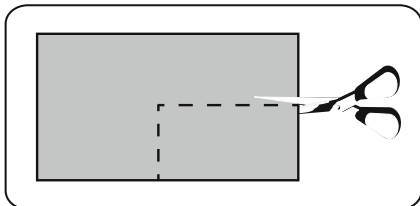

3. Apply only the amount of glue (not included) needed to cover the repair site.

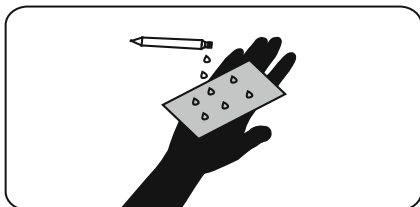

4. Press the repair patch firmly to repair site for 30 seconds.

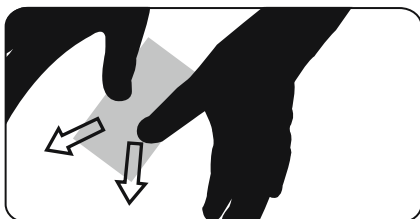

5. Wait 30 minutes before use.



Trittech PVC Material Repair Patch (2.5cm ≤ the size of broken ≤ 5 cm)

NOTE: Glue is not included due to shipping constraints. You can find PVC or silicone-based glue at most retail outlets. Carefully read the warning labels and closely follow instructions on the back of glue before attempting the following repair steps.

Bestway® | LIMITED WARRANTY

Bestway (Hong Kong) International Ltd. ("Bestway") warrants to the original end-user purchaser in the United States and Canada that the products identified in the table below ("Products") will be free from manufacturing defects for the warranty period identified for the Product in the table below. The warranty period begins on the date of purchase or the date of delivery of the Product to the original, end-user purchaser, whichever is later.

Because Bestway cannot control the quality of Products sold by unauthorized sellers, this warranty applies only to Products that were purchased from Bestway or a Bestway authorized seller in the United States and Canada, unless otherwise prohibited by law. Bestway reserves the right to reject warranty claims for Products purchased from unauthorized sellers, including unauthorized Internet sites.

This warranty does not cover any damage or defects due to:

- normal wear and tear;
- misuse, including use outside of the owner's manual guidelines;
- alteration to the product by the end-user or any third party;
- improper storage or handling, including storage or handling not in accordance with the technical recommendations in the owner's manual;
- negligence.

Bestway will repair or replace the damaged or defective part(s) only. Bestway will not repair or replace the complete set.

Purchasers of Products who wish to make a warranty claim based upon a Product defect should complete the warranty claim form found at <https://www.bestwayusa.com/ourwarranties>. You will be required to submit proof of purchase from an authorized seller. This warranty does not cover Products purchased as used or "second hand as is". Bestway reserves the right to request additional information in order to process a warranty claim, including, but not limited to, Product serial numbers or photos of the Product or parts. You may also be required to the return of the Product or certain parts for additional testing or to otherwise assist in processing your claim.

There are no warranties which extend beyond those stated herein. ANY IMPLIED WARRANTIES THAT MAY BE APPLICABLE TO PRODUCTS, INCLUDING IMPLIED WARRANTIES OF MERCHANTABILITY OR FITNESS FOR A PARTICULAR PURPOSE, ARE LIMITED IN DURATION TO THE DURATION OF THE APPLICABLE EXPRESS WARRANTY PERIOD DESCRIBED HEREIN. UNDER NO CIRCUMSTANCES SHALL BESTWAY BE LIABLE FOR ANY SPECIAL, INCIDENTAL, OR CONSEQUENTIAL DAMAGES BASED UPON BREACH OF THIS LIMITED WARRANTY, BREACH OF CONTRACT OR STRICT LIABILITY. Some States do not allow limitations on how long an implied warranty lasts, or the exclusion or limitation of incidental or consequential damages, so the above limitations or exclusions may not apply to you.

This warranty gives you specific legal rights, and you may also have other rights which vary from State to State.

If you have any questions about whether a seller is authorized or any other questions regarding this warranty, the warranty period, the warranty claim process or the status of a warranty claim, please contact us through the form at <https://bestwayusa.com/support> or write us at: Bestway Customer Service – 3435 S. McQueen Road – Chandler, AZ 85286

Note: Warranty claims can be submitted online at <https://bestwayusa.com/registration-warranty> for faster service.

Please choose your product type: ☐ Portable Hot Tub ☐ Above Ground Pool (AGP) ☐ Pool Accessory (ACC)
☐ Stand-up Paddleboard (SUP)

Date: _____ Date of Purchase: _____

Name: _____ Address: _____

Zip Code: _____ Retailer: _____

Country: _____ City: _____

Mobile: _____ Telephone: _____

Fax: _____ E-mail: _____

Serial Number: _____

Please write the problem you are having with your specific product. be as detailed as possible: _____

Mailing information: Bestway (USA), Inc.
Attn: Warranty
3435 S. McQueen Road
Chandler, AZ 85286



For support please visit us at:
bestwayusa.com/support

©2024 The Coleman Company, Inc.

Coleman® is a registered trademark of The Coleman Company, Inc., used under license.

©2024 Bestway Inflatables & Material Corp. All rights reserved.

Trademarks used in some countries under license from / Manufactured by Bestway Inflatables & Material Corp.,
No. 208 Jin Yuan Wu Road, Shanghai, 201812, China (Tel: +86 21 69135588).

Represented in North America by Bestway (USA) Inc., 3435 S. McQueen Road, Chandler, AZ 85286, United States of America.

www.bestwayusa.com