



©2023 Bestway Inflatables & Material Corp.

All rights reserved

Trademarks used in some countries under license from **Bestway Inflatables & Material Corp.**, Shanghai, China

Exported by **Bestway (Hong Kong) International Ltd./Bestway Enterprise Company Limited**

Suite 713, 7/Floor, East Wing, Tsim Sha Tsui Centre, 66 Mody Road, Kowloon, Hong Kong

Distributed in North America by **Bestway (USA) Inc.**, 3435 S. McQueen Road, Chandler, AZ 85286, United States of America

Tel: +86 21 69135588

www.bestwayusa.com

CLEAN SUN POWERED POOL PAD OWNER'S MANUAL TECHNICAL SAFETY INSTRUCTIONS

WARNING

READ AND FOLLOW ALL INSTRUCTIONS

WARNING-TO REDUCE THE RISK OF INJURY, do not permit children to use this product unless they are closely supervised at all times.

CAUTION- This product is for use with storable pools only. Do not use with permanently-installed pools. A storable pool is constructed so that it is capable of being readily disassembled for storage and reassembled to its original integrity. A permanently-installed pool is constructed in or on the ground or in a building such that it cannot be readily disassembled for storage.

CAUTION- Do not touch the panel surface when the product is working or you may get hurt.

NOTE: Do not sit, stand or jump on this product.

NOTE: Weather conditions can affect the performance and life span of your Clean sun powered pool pad.

NOTE: This product must be set up on a flat and clean location; the ground must be cleared of all objects and debris including stones and twigs.

NOTE: Grass or other vegetation under the product will die and may cause odors and slime to develop, therefore we recommend removing all grass from the selected location. Avoid locating the item over of beside areas prone to aggressive plant and weed species as they may damage the item when they grow.

NOTE: This product must be placed in direct sun light to ensure proper performance.

NOTE: Drawings for illustration purpose only. May not reflect actual product. Not to scale.

SPECIFICATIONS

| | |
|--------------------------|-------------------------------------------------------------------------------------------------------------------------------------------------------|
| Surface(m ²) | 1.88 |
| Length(m) | 1.71 |
| Width(m) | 1.1 |
| Max Pressure(Psi) | 10 |
| Material | PVC |
| Channel System | S-channel |
| Installation | On Lawn/On Flat |
| Characteristic | 50-100% of the swimming pool surface (Increase swimming pool water temperatures by approximately 3-5°C (5-9°F) Depending on the weather condition) |

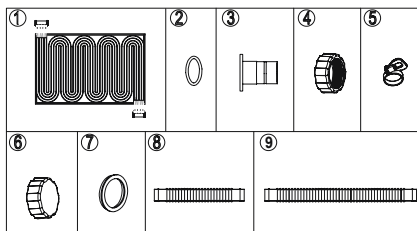

| NO. | DESCRIPTION | QTY. |
|-----|---------------------|------|
| 1 | Heat Panel | 1 |
| 2 | O-ring (Φ24 mm) | 4 |
| 3 | Hose Adapter | 4 |
| 4 | Adapter Nut | 4 |
| 5 | Hose Clamps | 4 |
| 6 | Adapter Cap | 2 |
| 7 | O-ring (Φ56 mm) | 4 |
| 8 | Hose (Φ32 mm x 2 m) | 1 |
| 9 | Hose (Φ32 mm x 3 m) | 1 |

ASSEMBLY INSTRUCTIONS

1. Unplug the filter pump or sand filter.
Loosen the hose clamps on the pool's inlet and outlet valves, replace the debris screens with stopper plugs (or close the connection valves) to stop water to flow.
2. Follow the below diagram instruction to assemble all the parts properly;
NOTE: Refer to the sand filter's owner's manual for assembly.
3. Loosen the hose clamps on the pool's inlet and outlet valves; replace the stopper plugs with debris screens (or open the connection valves of the pool) to allow water to flow.
4. Tighten the hose clamps, ensure no water is leaking and every connection is securely fastened.
NOTE: When the pad is filled with water, the pad will deform because of the water pressure, which is normal.

1

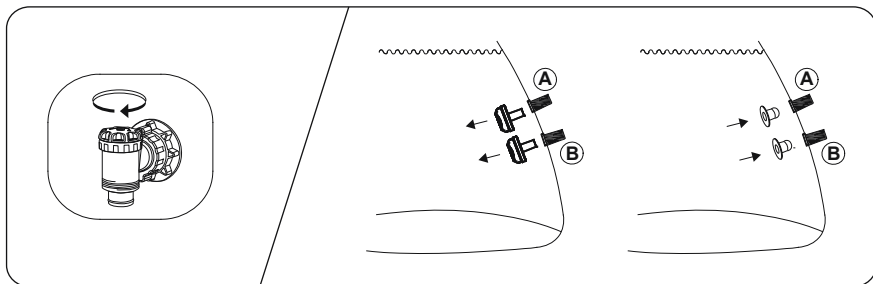

2

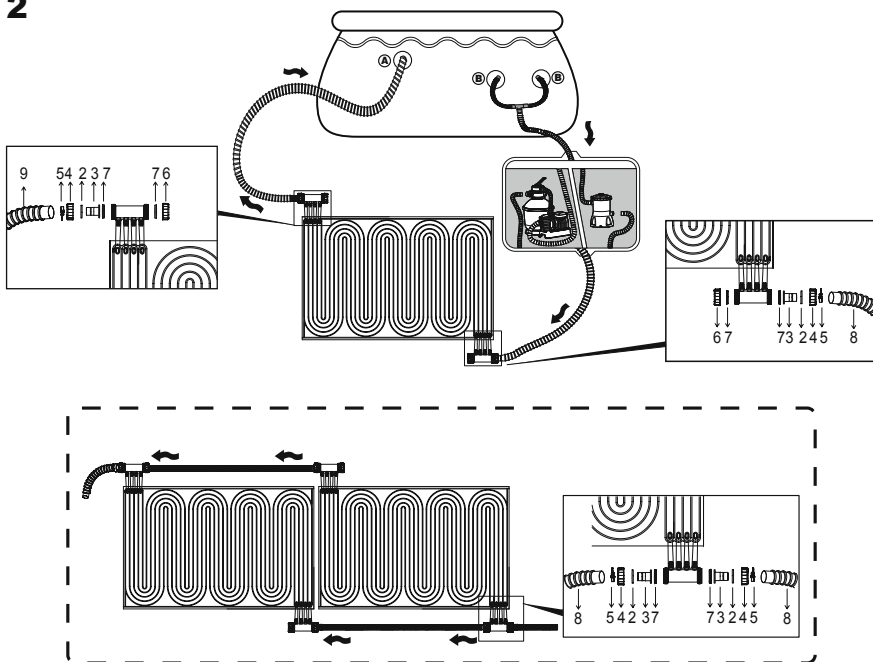

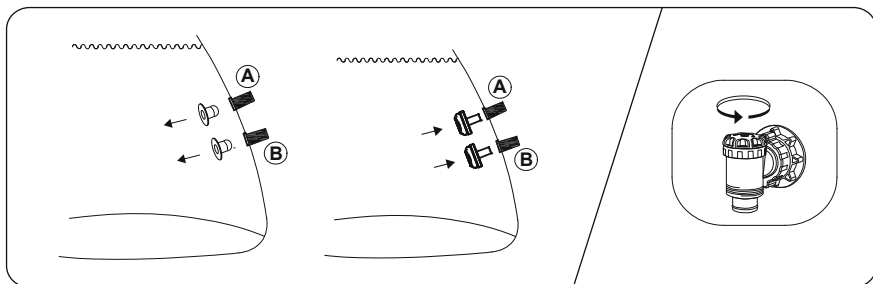

3





CLEAN SUN POWERED POOL PAD QUANTITY FOR BESTWAY POOLS

Number of clean sun powered pool pad recommended for larger pools. Based on 8 hours of sunshine exposure per day; heating performance varies depending on weather and ambient conditions, and whether the pool is covered or not at night.

| | Pump flow rate | | Recommend number of clean sun powered pool pad |
|-------------|----------------|-------|------------------------------------------------|
| | gal/h | L/h | |
| Filter Pump | 330 | 1,249 | 1 |
| | 530 | 2,006 | |
| | 800 | 3,028 | 2 |
| | 1,000 | 3,785 | |
| | 1,500 | 5,678 | 3 |
| | 2,500 | 9,463 | |
| Sand Filter | 800 | 3,028 | 2 |
| | 1,500 | 5,678 | 3 |
| | 2,200 | 8,327 | |

| Pool | Pool Size | Recommend QTY of pad |
|-------------------------------------------------------------------------------------|----------------------------------------------------------------|----------------------|
|  | 7 ft.3 in. x 59 in. x 17 in. (2.21 m x 1.50 m x 43 cm) | 1 |
| | 8 ft.6 in. x 67 in. x 24 in. (2.59 m x 1.70 m x 61 cm) | 1 |
| | 9 ft.10 in. x 6 ft.7 in. x 26 in. (3.00 m x 2.01 m x 66 cm) | 1 |
| | 12 ft. x 6 ft.7 in. x 26 in. (3.66 m x 2.01 m x 66 cm) | 1 |
| | 13 ft.1 in. x 6 ft.11 in. x 32 in. (4.00 m x 2.11 m x 81 cm) | 1 |
|  | 6 ft. x 20 in. (1.83 m x 51 cm) | 1 |
| | 8 ft. x 20 in. (2.44 m x 51 cm) | 1 |
| | 9 ft. x 26 in. (2.74 m x 66 cm) | 1 |
| | 10 ft. x 26 in. (3.05 m x 66 cm) | 1 |
| | 10 ft. x 30 in. (3.05 m x 76 cm) | 1 |
| | 12 ft. x 30 in. (3.66 m x 76 cm) | 1 |
| | 12 ft. x 33 in. (3.66 m x 84 cm) | 1 |
| | 12 ft. x 39.5 in. (3.66 m x 1.00 m) | 1 |
| | 12 ft. x 48 in. (3.66 m x 1.22 m) | 1 |
| | 13 ft. x 33 in. (3.96 m x 84 cm) | 1 |
| | 13 ft. x 42 in. (3.96 m x 1.07 m) | 1 |
| | 14 ft. x 33 in. (4.27 m x 84 cm) | 1 |
| | 14 ft. x 42 in. (4.27 m x 1.07 m) | 2 |
| | 14 ft. x 48 in. (4.27 m x 1.22 m) | 2 |
| | 15 ft. x 33 in. (4.57 m x 84 cm) | 1 |
| | 15 ft. x 42 in. (4.57 m x 1.07 m) | 2 |
| | 15 ft. x 48 in. (4.57 m x 1.22 m) | 2 |
| | 16 ft. x 42 in. (4.88 m x 1.07 m) | 2 |
| | 16 ft. x 48 in. (4.88 m x 1.22 m) | 2 |
| | 18 ft. x 48 in. (5.49 m x 1.22 m) | 3 |
| | 18 ft. x 52 in. (5.49 m x 1.32 m) | 3 |
|  | 20 ft. x 48 in. (6.10 m x 1.22 m) | 3 |
| | 20 ft. x 52 in. (6.10 m x 1.32 m) | 3 |
| | 22 ft. x 52 in. (6.71 m x 1.32 m) | 3 |
| | 24 ft. x 52 in. (7.32 m x 1.32 m) | 3 |
| | 26 ft. x 52 in. (7.93 m x 1.32 m) | 3 |
| | 9 ft.3 in. x 6 ft.5 in. x 33 in. (2.82 m x 1.96 m x 84 cm) | 1 |
| | 13 ft.3 in. x 6 ft.7 in. x 39.5 in. (4.04 m x 2.01 m x 1.00 m) | 1 |
| | 13 ft.6 in. x 6 ft.7 in. x 48 in. (4.12 m x 2.01 m x 1.22 m) | 1 |
| | 16 ft. x 8 ft. x 48 in. (4.88 m x 2.44 m x 1.22 m) | 2 |
| | 16 ft. x 16 ft. x 48 in. (4.88 m x 4.88 m x 1.22 m) | 3 |
| | 18 ft. x 9 ft. x 48 in. (5.49 m x 2.74 m x 1.22 m) | 3 |
| | 18 ft. x 9 ft. x 52 in. (5.49 m x 2.74 m x 1.32 m) | 3 |
| | 21 ft. x 9 ft. x 52 in. (6.40 m x 2.74 m x 1.32 m) | 3 |

| | | |
|-----------------------------------------------------------------------------------|-----------------------------------------------------------|---|
|  | 22 ft. x 12 ft. x 52 in. (6.71 m x 3.66 m x 1.32 m) | 3 |
| | 24 ft. x 12 ft. x 52 in. (7.32 m x 3.66 m x 1.32 m) | 3 |
| | 31 ft.4 in. x 16 ft. x 52 in. (9.56 m x 4.88 m x 1.32 m) | 3 |
|  | 16 ft. x 10 ft. x 42 in. (4.88 m x 3.05 m x 1.07 m) | 2 |
| | 18 ft. x 12 ft. x 48 in. (5.49 m x 3.66 m x 1.22 m) | 2 |
| | 8 ft. x 24 in. (2.44 m x 61 cm) | 1 |
| | 8 ft. x 26 in. (2.44 m x 66 cm) | 1 |
| | 9 ft. x 30 in. (2.74 m x 76 cm) | 1 |
| | 10 ft. x 26 in. (3.05 m x 66 cm) | 1 |
| | 10 ft. x 30 in. (3.05 m x 76 cm) | 1 |
| | 12 ft. x 30 in. (3.66 m x 76 cm) | 1 |
| | 13 ft. x 33 in. (3.96 m x 84 cm) | 1 |
| | 15 ft. x 33 in. (4.57 m x 84 cm) | 1 |
|  | 15 ft. x 42 in. (4.57 m x 1.07 m) | 1 |
| | 10 ft. x 6 ft.7 in. x 33 in. (3.05 m x 2.00 m x 84 cm) | 1 |
| | 14 ft. x 8 ft.2 in. x 39.5 in. (4.27 m x 2.50 m x 1.00 m) | 1 |
| | 16 ft. x 10 ft. x 42 in. (4.88 m x 3.05 m x 1.07 m) | 2 |
| | 18 ft. x 9 ft. x 48 in. (5.49 m x 2.74 m x 1.22 m) | 3 |
| | 20 ft. x 12 ft. x 52 in. (6.10 m x 3.66 m x 1.32 m) | 3 |
| | 24 ft. x 12 ft. x 52 in. (7.32 m x 3.66 m x 1.32 m) | 3 |

MAINTENANCE

CAUTION: YOU MUST ENSURE THE SAND FILTER IS UNPLUGGED BEFORE ANY MAINTENANCE BEGINS OR SEVERE RISK OF INJURY OR DEATH EXISTS.

- 1) Unplug the filter pump or sand filter.
- 2) Loosen all the hose clamps.
- 3) Remove debris screens from inside of pool. Replace the debris screens with the stopper plugs in the pool's inlet and outlet valves. (Or close the connection valves A or B.)
- 4) Clean the panels with a garden hose carefully.

STORAGE

- 1) Unplug the filter pump or sand filter.
- 2) Follow the instructions as previously outline to stop water flowing to the filter pump or sand filter.
- 3) Detach all hoses.
- 4) Dry all components thoroughly.
- 5) Roll all the panels.
- 6) Store the product in a dry warm location out of child's reach.