

# Bestway®

## FLOWCLEAR™



### 58516E

### OWNER'S MANUAL

[bestwayusa.com/support](http://bestwayusa.com/support)

Visit the Bestway YouTube channel 





# OWNER'S MANUAL

## 58516E Sand Filter



Visit the Bestway YouTube channel

### SAFETY INSTRUCTIONS

## WARNING

## IMPORTANT SAFETY INSTRUCTIONS

When installing and using this electrical equipment, basic safety precautions should always be followed, including the following:

## READ AND FOLLOW ALL INSTRUCTIONS

**WARNING** - TO REDUCE THE RISK OF INJURY - do not permit children to use this product unless they are closely supervised at all times.

**WARNING** - RISK OF ELECTRIC SHOCK - Connect only to a grounding type receptacle. This product is provided with a ground-fault circuit-interrupter. If replacement of the plug is needed, use only identical replacement parts.

**WARNING** - The unit is provided with a ground-fault circuit-interrupter (GFCI). To test the GFCI, push the test button. The GFCI should interrupt power. Push the reset button. Power should be restored. If the GFCI fails to operate in this manner, the GFCI is defective. If the GFCI interrupts power to the pump without the test button being pushed, a ground current is flowing, indicating the possibility of an electric shock. Do not use this pump. Disconnect the pump and have the problem corrected by a qualified service representative before using.

**CAUTION** - To reduce the risk of electric shock the pool must be installed no closer than 6 feet (1.8 m) from any electrical outlet. Do not place portable appliances closer than 5 feet (1.5 m) from the pool.

**DO NOT BURY CORD** - Locate cord to minimize abuse from lawn mowers, hedge trimmers, and other equipment.

**WARNING** - To reduce the risk of electric shock, replace damaged cord immediately.

**WARNING** - To reduce the risk of electric shock, do not use extension cord to connect unit to electric supply; provide a properly located outlet.

**CAUTION:** This pump is for use with storable pools only. Do not use with permanently-installed pools. A storable pool is constructed so that it is capable of being readily disassembled for storage and reassembled to its original integrity. A permanently-installed pool is constructed in or on the ground or in a building such that it cannot be readily disassembled for storage. Please examine and verify all sand filter

components are present before use. Notify Bestway at the customer service address listed on this manual for any damaged or missing parts at the time of purchase.

• THERMALLY PROTECTED MOTOR. CSA ENCLOSURE 3

• FOR USE WITH SWIMMING POOLS ONLY.

**CAUTION:** TO ENSURE CONTINUED PROTECTION AGAINST SHOCK HAZARD, USE ONLY IDENTICAL REPLACEMENT PARTS WHEN SERVICING.

**WARNING:** RISK OF ELECTRIC SHOCK. CONNECT ONLY TO A GROUNDING TYPE RECEPTACLE.

**CAUTION:** THIS PUMP IS FOR USE WITH STORABLE POOLS ONLY - DO NOT USE WITH PERMANENTLY-INSTALLED POOLS.

**CAUTION:** CONNECT ONLY TO GROUNDING TYPE RECEPTACLE PROTECTED BY A CLASS A GROUND FAULT CIRCUIT INTERRUPTER.

**CAUTION:** FOR CONTINUED PROTECTION AGAINST POSSIBLE ELECTRIC SHOCK THIS UNIT IS TO BE MOUNTED TO THE BASE IN ACCORDANCE WITH THE INSTALLATION INSTRUCTIONS.

**WARNING - RISK OF ELECTROCUTION**

- 1) Connect Only To Properly Grounded Outlet. Do Not Remove Ground Pin.
- 2) Inspect Cord Before Using – Do Not Use If Cord Is Damaged.
- 3) Keep Ground-Fault Circuit-Interrupter Dry And Off The Ground.
- 4) Do Not Touch Plug With Wet Hands.
- 5) Double Insulated – When Servicing Use Only Identical Replacement Parts.
- 6) Read Instruction Manual Before Using.

**DO NOT REMOVE THIS TAG**

**SAVE THESE INSTRUCTIONS.**

This device complies with part 15 of the FCC Rules. Operation is subject to the following two conditions: (1) This device may not cause harmful interference, and (2) this device must accept any interference received, including interference that may cause undesired operation.

**WARNING:** Any changes or modifications to this unit not expressly approved by the party responsible for compliance could void the user's authority to operate the equipment.

**NOTE:** This equipment has been tested and found to comply with the limits for a Class B digital device, pursuant to part 15 of the FCC Rules. These limits are designed to provide reasonable protection against harmful interference in a residential installation. This equipment generates, uses and can radiate radio frequency energy and, if not installed and used in accordance with the instructions, may cause harmful interference to radio communications. However, there is no guarantee that interference will not occur in a particular installation. If this equipment does cause harmful interference to radio or television reception, which can be determined by turning the equipment off and on, the user is encouraged to try to correct the interference by one or more of the following measures:

- Reorient or relocate the receiving antenna.
- Increase the separation between the equipment and receiver.
- Connect the equipment into an outlet on a circuit different from that to which the receiver is connected.
- Consult the dealer or an experienced radio/ TV technician for help.

# POOL SUCTION FITTING INSTRUCTIONS

When installing and using this equipment, basic safety precautions shall always be followed, including the following:

## IMPORTANT SAFETY INSTRUCTIONS READ, FOLLOW, AND UNDERSTAND ALL INSTRUCTIONS AND WARNINGS.

- Any modification that increases the flow rate of the circulation system shall require re-evaluation of the cover/grate and sump to ensure that the flow rating of the Suction Outlet Fitting Assembly (SOFA) is not exceeded.
  - Missing, broken, or cracked cover/grates, sumps, mud-frames, or any other SOFA component shall be replaced before bathers are allowed to use the pool.
  - Loose cover/grates shall be reattached before bathers are allowed to use the pool.
1. Replace suction fittings every 2 years.
  2. The use of adhesives or other attachment methods that prevent access to suction piping or SOFA components requiring periodic servicing is prohibited.
  3. Refer to the following diagram for each SOFA component part instructions:
  4. - Any field modification made to a SOFA not authorized by the manufacturer's installation instructions shall void the SOFA certification.
    - No modification shall be made to a SOFA structure or flow path unless the new configuration has been certified as new SOFA.
    - Cover/grates and all other SOFA components shall be replaced at or before the end of their service life and that service life begins the month and year in which a SOFA component is installed with or without water.
  5. Winterizing instructions. Dry the suction fittings completely, and store the product in a dry room at a storage temperature of 15 °C ~ 40 °C.
  6. Use the screwdriver (not included) to disassemble the suction fitting to clean or service.
    - Cover/grate, including fasteners, shall be observed for damage or tampering each operational day.
    - Missing, broken, or cracked cover/grates shall be replaced before bathers are allowed to use the pool.
    - Loose cover/grates and associated components shall be reattached before bathers are allowed to use the pool.
    - SOFA components and fastener receptacles shall be clean and free of debris or obstructions during installation of cover/grate and fasteners.
    - Remember to hand-check cover/grate for snugness to the sump/ frame after installation.

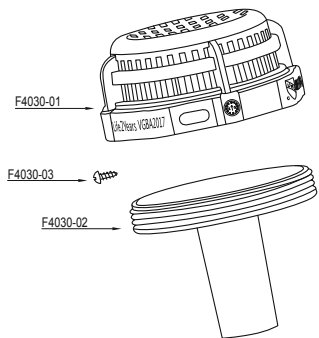

7. Before using the product, please check the integrity of the head of the suction fitting. If the product is broken, cracked, or the color has significantly faded, please do not use it.
8. - All SOFAs shall be installed in accordance with the manufacturer's installation instructions.
  - No modification shall be made to a SOFA structure or flow path unless the new configuration has been certified to the original SOFA.
  - These SOFA-configuration specific flow ratings NOT be exceeded at any time the pool is open to bathers.
  - Cover/grates, when installed, shall not protrude more than 2 in. (51 mm) from the finished surface of the pool in which the SOFA is installed.
- 9.

Installation Information label (copy)

Manufacturers name:  
GOLEADER INDUSTRIES (JINHUA) CO., LTD.  
Cover part number: F4030  
Service life of the cover: 2 Years  
Cover flow rating: 28 GPM  
Installer needs to fill in the balance of the information and permanently post it as near as feasible to the pump control. Keep a copy of this information with the other important pool related documents.  
Configuration and installed orientation: \_\_\_\_\_  
Location: \_\_\_\_\_  
Installed Date: \_\_\_\_\_

Please research and download General Certificate of Conformity through [www.bestwayusa.com](http://www.bestwayusa.com)

# SAVE THESE INSTRUCTIONS

## GFCI WARNING

**WARNING:** Risk of electric shock. The GFCI must be tested before each use.

**WARNING:** Do not use the pump if this test fails. For assistance, please visit the support section on our website, [www.bestwayusa.com](http://www.bestwayusa.com).

# SPECIFICATIONS

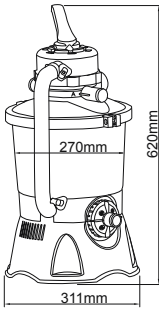

Filter Diameter	270 mm
Effective Filter Area:	0.059 m <sup>2</sup> (0.635 ft <sup>2</sup> )
Max. Operating Pressure:	0.42 Bar (6 PSI)
Working sand filter pressure:	<0.25 Bar (3.5 PSI)
Max. Water Temperature:	35°C
Sand:	Not included
Sand Size:	#20 silica sand, 0.45-0.85 mm
Sand Capacity:	Approximately 8.5 kg

# PARTS REFERENCE OVERVIEW

Before assembling the sand filter, take a few minutes to become familiar with all the sand filter parts.

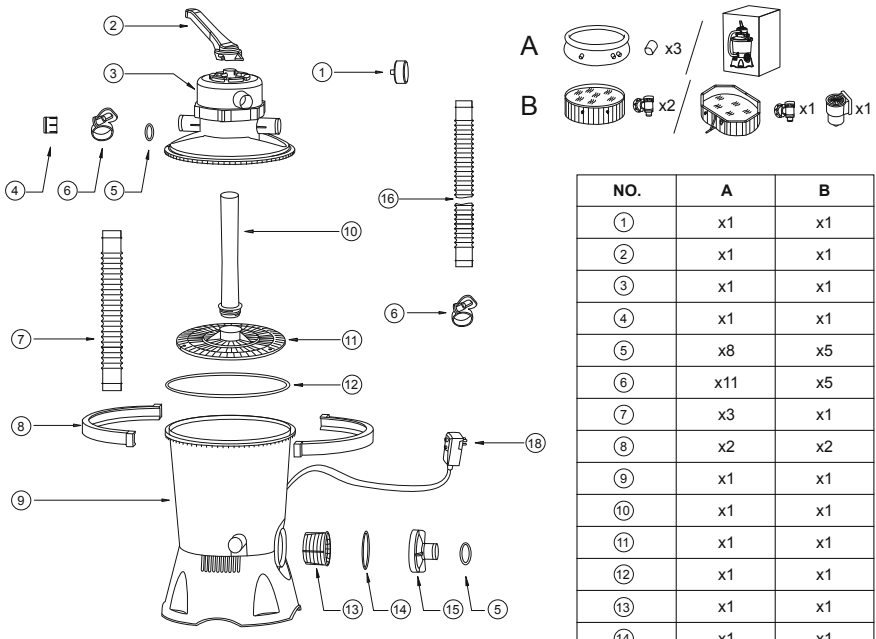

NO.	A	B
①	x1	x1
②	x1	x1
③	x1	x1
④	x1	x1
⑤	x8	x5
⑥	x11	x5
⑦	x3	x1
⑧	x2	x2
⑨	x1	x1
⑩	x1	x1
⑪	x1	x1
⑫	x1	x1
⑬	x1	x1
⑭	x1	x1
⑮	x1	x1
⑯	x2	x2
⑰-1	x2	x0
⑰-2	x1	x0
⑱	x1	x1
⑲	x1	x0

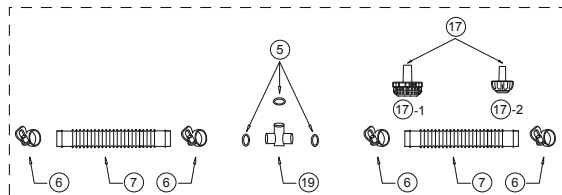

# ASSEMBLY

(You will need a screwdriver.)



1. Carefully remove all components from the package and check to ensure nothing is damaged. If equipment is damaged, immediately notify the retailer from where the equipment was purchased.
2. The sand filter should be placed on solid, level ground, preferably a concrete slab. Position the sand filter so the Ports and Control Valve are accessible for operation, servicing and winterizing.
3. The sand filter must be vertically fixed on ground or a certain pedestal made of wood or concrete before use to prevent the sand filter from accidental falling. Fully assembled sand filter will exceed 18 kg. The mounting holes should be 8 mm in diameter and spaced 285 mm apart. Use two bolts and nuts with a maximum of 8 mm in diameter to fasten the sand filter to the pedestal.

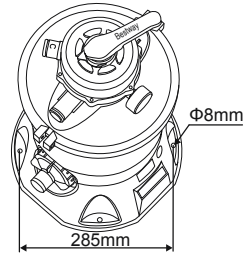

## LOAD POOL-GRADE FILTER SAND/FLOWCLEAR™ POLYSPHERE.

**NOTE:** Use only special pool-grade filter sand, free of all limestone or clay: #20 Silica sand 0.45-0.85 mm, approximately one 8.5 kg bag should suffice. If you do not use the recommended size filter sand, filtering performance will be reduced and the sand filter may be damaged, thereby voiding warranty.

**NOTE:** To avoid damaging the Skimmer when adding sand, pour some water into the Bottom Tank to submerge the Skimmer on the Collector Hub.

**NOTE:** Sand/Flowclear™ Polysphere not included.

**NOTE:** Use 28 g (0.06 lbs) Flowclear™ Polysphere to replace 1 kg (2.20 lbs) sand.

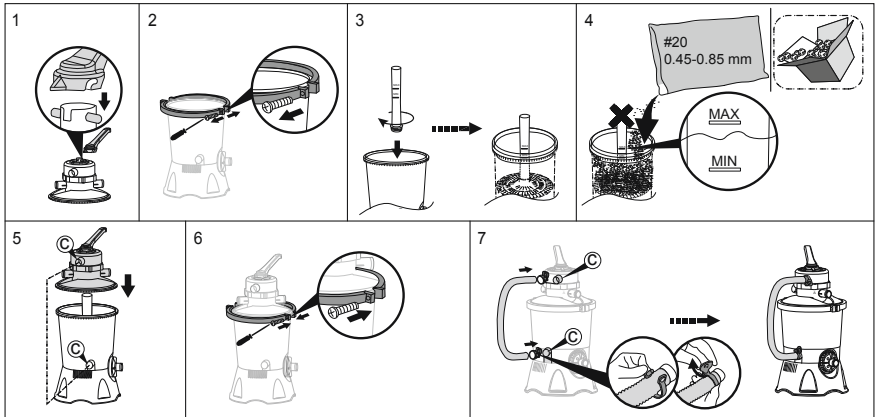

# CONNECT TO THE POOL

V1.1

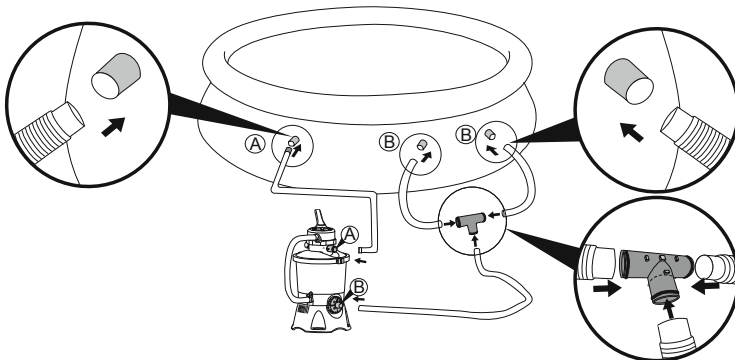

V1.2

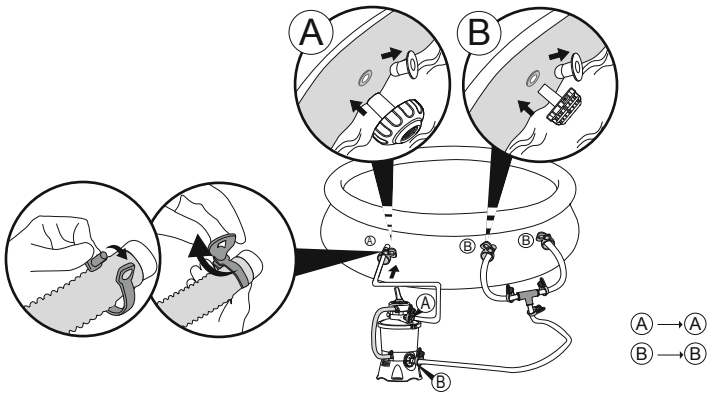

V2

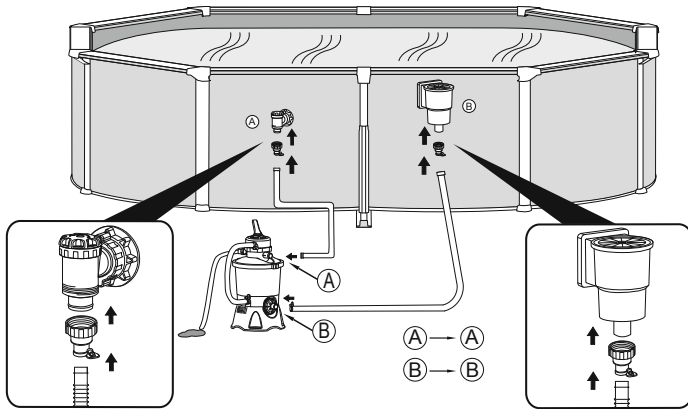

## LOWERING OR DRAINING POOL WATER

1

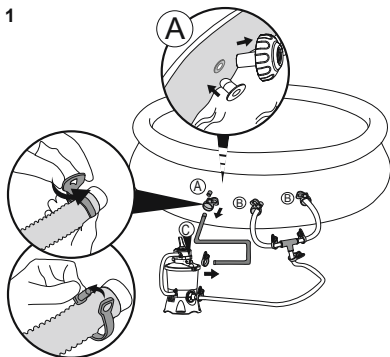

2

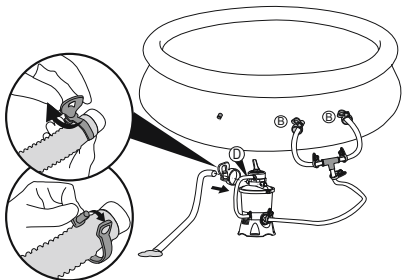





**STOP**

Before switching on, please read the manual carefully.

## GFCI TEST

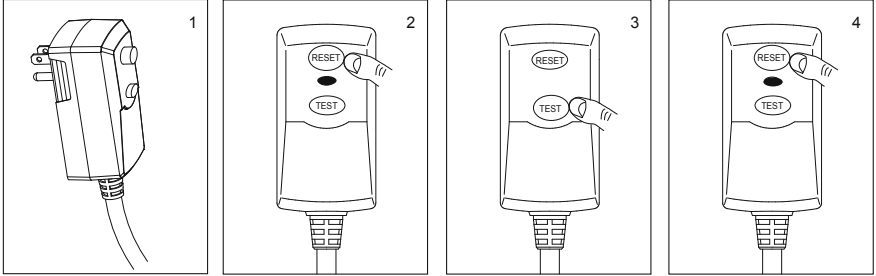

## OPERATION

### CONTROL VALVE OVERVIEW

**WARNING:** To prevent equipment damage and possible injury, always switch off sand filter before changing the Control Valve function. Changing valve positions while the pump is running can damage the Control Valve, which may cause personal injury or property damage.

How to Use the Control Valve:

Press down on the Control Valve handle and rotate to desired function.

### CONTROL VALVE FUNCTIONS

The Control valve is used to select 6 different filter functions: Filter, Rinse, Circulate, Backwash, Closed and Drain.

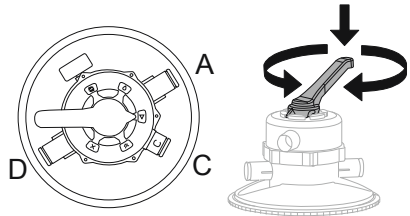

**Filter:** This function is used to filter pool water and should be positioned here 99% of the time. Water is pumped through the sand filter, where it is cleaned and returned to the pool.

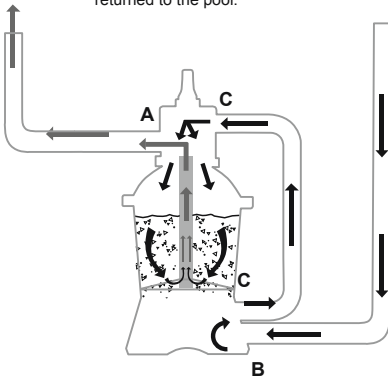

**Closed:** This function stops water flowing between the sand filter and the pool.

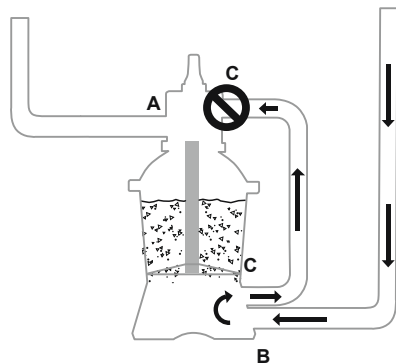



**Backwash:** This function is used to clean the sand bed; water is pumped down through the Collector Hub, upwards through the sand bed, and deposited out of Port D.

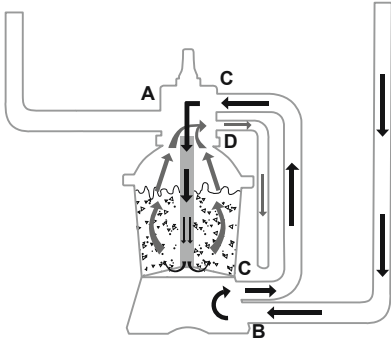

**Rinse:** This function for initial startup, cleaning, and sand bed leveling after Backwash; water is pumped downwards through the sand bed, up through the Collector Hub and deposited out of the valve Port D.

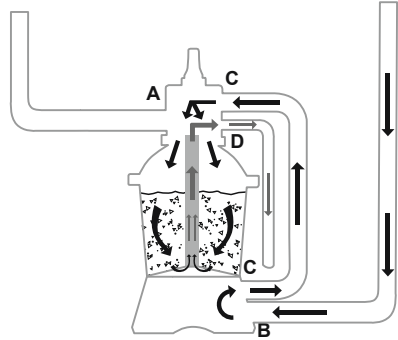

**Drain:** This function drains water from the pool; another filter by pass setting, water is pumped and deposited out of Port D, instead of returning it to the pool.

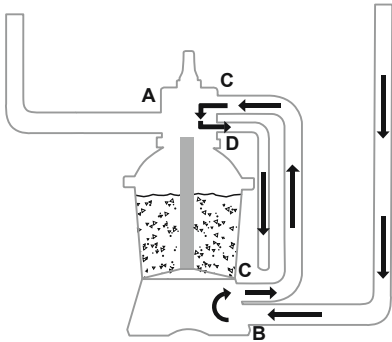

**Circulate:** This function circulates pool water by passing the sand filter; use this function if the filter is broken to collect debris in the Debris Screens.

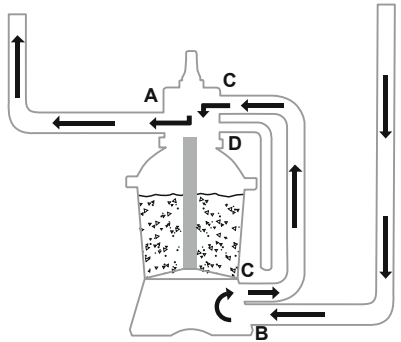

**NOTE:**

- Be sure all provisions for wastewater disposal meet applicable local, state or national codes. Do not discharge water where it will cause flooding or damage.
- When the Control Valve is set to the Backwash, Rinse, or Drain position, water will discharge from Port D on the Control Valve.
- Do not switch on or operate the sand filter with the Control Valve set to the Closed function or it will seriously damage the sand filter.
- Do not set the Control Valve between two functions, or it will lead to leaking.
- To avoid water leakage, insert the Port D Cap onto the Control Valve Port D before operating the sand filter.

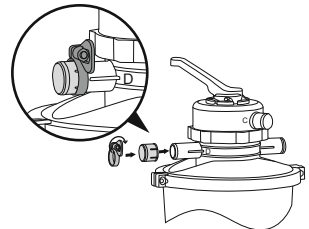

**AIR RELEASE**

Press down the control valve handle and wait until the water flow from Port D to release the air.

**NOTE:** It is important to repeat this operation every time you start the pump after winterizing, maintenance and backwashing the sand bed.

## FIRST TIME USE INSTRUCTIONS

**Backwash and Rinsing** must be performed to prepare the pump for its first use and to wash the sand.

### CAUTION: DO NOT DRY RUN THE SAND FILTER

1. Press down on the Control Valve handle and rotate to the Backwash function.
2. Plug in and run the sand filter for 3-5 minutes, or until the water runs clear.
3. Switch off the sand filter and set the Control Valve to the Rinse function.
4. Switch on the sand filter and run the sand filter for 1 min. This circulates water backwards through the sand filter and drains water out Port D.
5. Switch off the sand filter. Set the Control Valve to the Closed function.
6. Top up pool water if required.



**IMPORTANT:** This procedure removes water from the pool, which you'll need to replace. Switch off the sand filter immediately if water levels near the pool's Inlet and Outlet valves.

1. Now the sand filter is ready for use. Set the Control Valve to the Filter function.

**NOTE:** To prevent the risk of electrical shock dry any excess water from yourself and the sand filter.

2. Switch on the sand filter to run it.

**NOTE:** The sand filter has now started its filtering cycle. Check that water is returning to the pool and take note of the filter pressure on Pressure Gauge. Generally, the recommended sand filter pressure is less than 0.25 Bar (3.5 PSI) when it is running.

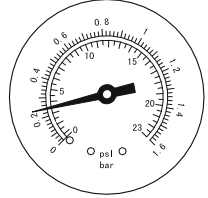

## SAND FILTER MAINTENANCE

**CAUTION:** You must ensure the sand filter is switched off and unplugged before any maintenance begins or severe risk of injury or death exists. As dirt builds up in the sand filter, the pressure reading on Pressure Gauge will increase. When the Pressure Gauge is 0.25 Bar (3.5 PSI) or higher, or water flow to the pool is too low, it is time to clean the sand. To clean the sand bed, follow all instructions outlined previously in: **Backwash and Rinsing**.

**NOTE:** Pressure gauge is for maintenance purpose only, and the pressure gauge value is just for reference, it should not be used as a precision instrument.

**NOTE:** We recommend you clean the sand bed once a month or less regularly depending on how often the pool is used. Do not clean the sand too frequently.

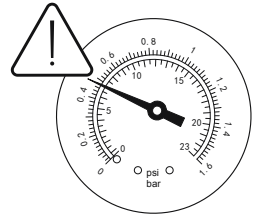

## CLEANING THE STRAINER

1. Switch off the sand filter and set the Control Valve to the Closed function.
2. Replace the Debris Screens with Stopper Plugs to prevent water from escaping.
3. Remove the Strainer Cover by unscrewing it.
4. Take out the Strainer, remove any debris.
5. Put the Strainer back into position. Ensure the hole in the strainer is aligned.
6. Ensure the Seal Ring is in place. Secure the Strainer Cover back.
7. Remove the Stopper Plugs and insert the Debris Screens.

**NOTE:** The Strainer must be emptied and cleaned periodically.

A dirty or blocked strainer will reduce the performance of the sand filter.

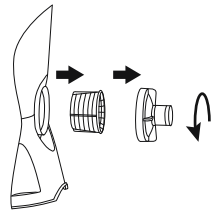

## LOWERING OR DRAINING POOL WATER

1. Switch off the sand filter and set Control Valve to the Drain function.
  2. Detach the Hose from the pool's Port A and sand filter Port A and attach to Port D.
- NOTE:** Remember to replace the Debris Screen with Stopper Plug to prevent water from escaping.
3. Switch on the sand filter and press the "RESET" button to run the filter and remove the pool water.

**WARNING: DO NOT DRY RUN THE SAND FILTER.**

## STORAGE

In areas that have freezing winter temperatures, pool equipment must be winterized to protect against damage. Allowing water to freeze will damage the sand filter and void warranty.

1. Backwash the sand filter.
2. Drain the pool according to the pool owner's manual.
3. Disconnect the two Hoses from the pool and the sand filter.
4. Completely pour the sand out of the tank and dry all components.
5. Store the sand filter in a dry location out of child's reach.

# TROUBLESHOOTING

Problems	Probable Causes	Solutions
Sand Filter does not operate	<ul style="list-style-type: none"> <li>- GFCI broken</li> </ul>	<ul style="list-style-type: none"> <li>- For assistance, please visit the support section on our website, <a href="http://www.bestwayusa.com">www.bestwayusa.com</a>.</li> </ul>
Sand is flowing to the pool	<ul style="list-style-type: none"> <li>- Sand is too small</li> <li>- Move the control valve from the backwash to the filter function without stop the sand filter</li> <li>- The level of the sand is too high</li> <li>- The skimmer was broken</li> </ul>	<ul style="list-style-type: none"> <li>- Recommend 0.45 mm to 0.85 mm #20 silica sand</li> <li>- Stop the sand filter every time set the control valve</li> <li>- Check if the level of the sand is between the marked "MAX" and "MIN" on the hub</li> <li>- Replace the skimmer</li> </ul>
No water flow	<ul style="list-style-type: none"> <li>- Stopper plugs were not removed</li> <li>- Air was not released</li> <li>- The control valve is set to Closed</li> <li>- The strainer is blocked</li> <li>- Sand filter broken</li> </ul>	<ul style="list-style-type: none"> <li>- Remove the stopper plugs and insert the debris screens</li> <li>- Release the air</li> <li>- Set to filter function</li> <li>- Clean the strainer</li> <li>- Call for service</li> </ul>
Excessive filter pressure	<ul style="list-style-type: none"> <li>- Dirty filter</li> <li>- Calcified sand bed</li> <li>- Insufficient backwashing</li> <li>- The pressure gauge was broken</li> </ul>	<ul style="list-style-type: none"> <li>- Backwash</li> <li>- Inspect sand and change if necessary</li> <li>- Backwash until effluent runs clear</li> <li>- Replace the pressure gauge</li> </ul>
Control Valve leaks from the port D	<ul style="list-style-type: none"> <li>- Control Valve was set between two functions</li> <li>- The gasket was broken</li> </ul>	<ul style="list-style-type: none"> <li>- Set to one function</li> <li>- Replace the gasket</li> </ul>
Connectors leaks	<ul style="list-style-type: none"> <li>- O-ring on the hose connection was broken</li> <li>- Loose Hoses</li> </ul>	<ul style="list-style-type: none"> <li>- Replace the o-ring</li> <li>- Tighten them</li> </ul>
GFCI LED flash	<ul style="list-style-type: none"> <li>- Plug may be loose in the socket; the internal metal part of the plug doesn't guarantee a secure connection</li> </ul>	<ul style="list-style-type: none"> <li>- Replace the socket</li> <li>- Replace the pump</li> </ul>

For support please visit us at:  
[bestwayusa.com/support](http://bestwayusa.com/support)

©2022 Bestway Inflatables & Material Corp.

All rights reserved

Trademarks used in some countries under license from Bestway Inflatables & Material Corp., Shanghai, China

Exported by Bestway (Hong Kong) International Ltd./Bestway Enterprise Company Limited

Suite 713, 7/Floor, East Wing, Tsim Sha Tsui Centre, 66 Mody Road, Kowloon, Hong Kong

Distributed in North America by Bestway (USA) Inc., 3435 S. McQueen Road, Chandler, AZ 85286, United States of America

Tel: +86 21 69135588

[www.bestwayusa.com](http://www.bestwayusa.com)

**Bestway**