

ATTACHING THE BREATHING TUBES

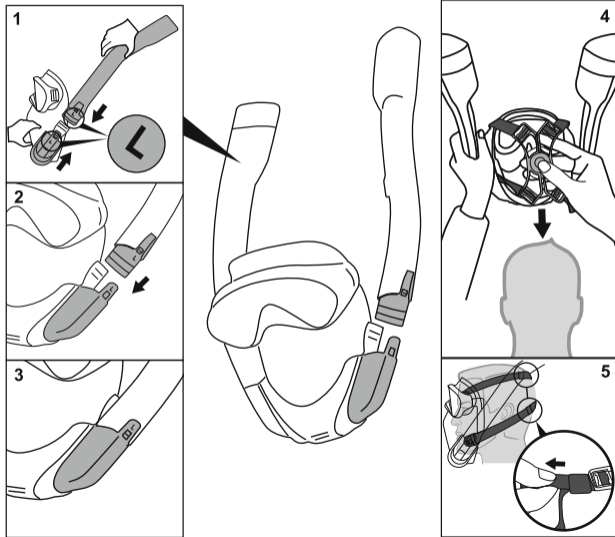

2

USE AND ASSEMBLY INSTRUCTIONS

ATTACHING THE BREATHING TUBES:

1. Push the L/R tube and click into its place. Refer to Figure 1&2&3.
2. Ensure the buckle on the straps is locked before usage. Hold both sides of the mask and place onto your face properly, sliding the straps to make sure the mask skirt seals the face comfortably and tightly. Refer to Figure 4&5.

DO NOT push with excessive force when attaching the Breathing Tube to the Snorkel Mask, as this may affect the leak-proof seal.

If you are having trouble attaching the Breathing Tube and Snorkel Mask, there may be sand or debris present. Rinse all parts and make sure there is no debris remaining, then try attaching it again.

NOTE:

If the mask is positioned incorrectly, water may enter into the chin and forehead areas. Please adjust the headband and straps to securely fit around your head.

3

REMOVING THE BREATHING TUBE

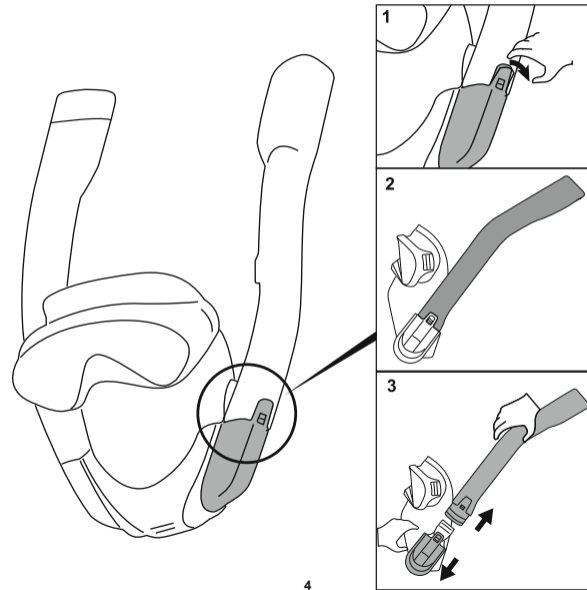

4

SAFETY FIRST

This product is designed for snorkeling purposes only. Do not use for any other purpose.

Always inspect product and parts before every use. If you find any cracks, punctures, irregularities, or any other damage, DO NOT USE.

Do not dive face-first into water, as this may shatter the mask and cause serious bodily injuries.

Do not scuba dive, free dive, or perform intensive swimming with this product. This product is not designed for such strenuous breathing activities.

Do not disassemble, modify, attach unauthorized accessories, or attempt repair of any product or part, as this may lead to serious injury, accidents and will void your snorkel's warranty.

If you experience any dizziness, light-headedness, or shortness of breath while using this product, stop use immediately.

PRECAUTIONS

Before each use, check that there is no sand or other debris on or in the Snorkel Mask and Breathing Tube. If you find any sand or debris, rinse with water.

Always perform a seal test to check the quality of the leak-proof seal.

The Bestway logo is written in a bold, rounded, sans-serif font. The letters are black with a thick white outline, giving it a 3D or embossed appearance. A registered trademark symbol (®) is located at the top right of the 'y'.

©2023 Bestway Inflatables & Material Corp.

All rights reserved

Trademarks used in some countries under license from Bestway Inflatables & Material Corp., Shanghai, China

Exported by Bestway (Hong Kong) International Ltd./Bestway Enterprise Company Limited

Suite 713, 7/Floor, East Wing, Tsim Sha Tsui Centre, 66 Mody Road, Kowloon, Hong Kong

Distributed in North America by Bestway (USA) Inc., 3435 S. McQueen Road, Chandler, AZ 85286, United States of America

Tel: +86 21 69135588

www.bestwayusa.com

NOTE: This equipment enables you to see underwater and breathe on the surface without taking your face out of the water. Use correctly for optimum performance.

NOTE: Do keep in mind how far you have swum, the return journey may be exhausting.

NOTE: If you want to venture below 3m (9-10 ft.) do seek advice from a properly qualified instructor (i.e.a member of the National Underwater Instructor's Association) or from a branch of the British Sub-Aqua Club or any similar organization.

NOTE: BE WARNED that as you descend, your natural buoyancy decreases. This means that you may have to swim upwards before you can begin to float back to the surface.

Maintenance and Storage:

Avoid unnecessary exposure to sunlight and air. Avoid contact with oils and greases. Some sun creams and lotions are of an oily composition. Avoid exposure to heat and contact with hot surfaces.

Store in a cool, dry and dark place in a box or bag. Do not distort during storage. Please research and download product declaration of conformity through www.bestwaycorp.com.