

# Owner's Manual

## Snow Tube

### WARNING

This is not a lifesaving device.

Do not leave children unattended while device is in use.

Do not tow behind any vehicle.

Do not exceed the manufacturer's recommended number of riders or weight capacity.

Product has no brakes or steering. Do not use near streets, roadways, driveways or sidewalks. Do not use near the proximity of trees or other fixed objects.

Product will gain high speeds under certain snow conditions; Excessive speed can cause loss of control and/or serious injury.

Use of this product involves inherent risk of injury or death.

Do not kneel on product during use.

Do not use in the water as a floating device.

Wearing helmets and safety goggles is strongly recommended.

Do not use on ice or any surface other than snow due to loss of control and maneuverability.

### ASSEMBLY

**IMPORTANT:** For best results, inflate and deflate the snow tube in a warm room.

When the temperature is below 0°C (32°F), the valve can become hard to open.

1. If the snow tube comes with a cloth cover, place the tube into the cover before inflation.

2. Inflation should be done by an adult only. Fill the chambers until most of the wrinkles are gone and the product feels firm to the touch but NOT hard. Do not over-inflate the product. Do not use an air compressor to inflate this product.

**Note:** Under and over-inflation of the product will result in safety hazards

3. Ensure that all valves are closed before using.

**Note:** Never stand on or leave objects on the product during inflation. Always check air leakage before using.

4. If the product is equipped with a rope, please attach it to the product according to the following steps.

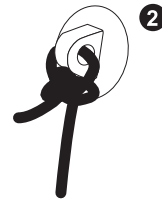
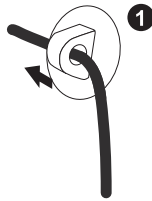

### INFLATION

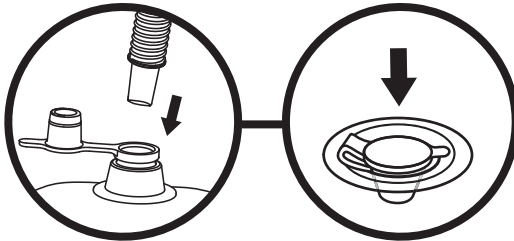

### DEFLATION

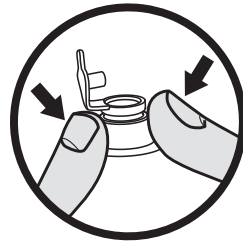

### MAINTENANCE AND STORAGE

1. After deflation, use a damp cloth to gently clean all surfaces.

**Note:** Never use solvents or other chemicals that may damage the product.

2. Store in a cool, dry place and out of children's reach.

3. Check the product for damage at the beginning of each season and at regular intervals when in use.



## REPAIR

If a chamber is damaged use the provided repair patch to fix it.

1. Fully deflate the product before repairing it.
2. Fully clean the area to be repaired.
3. Cut the correct size needed from the repair patch material.
4. Apply only the amount of glue needed to cover the repair site. (Glue not included)
5. Press the patch over the area to be repaired.
6. Wait 30 minutes before inflating the product.



---

©2022 Bestway Inflatables & Material Corp.

All rights reserved

Trademarks used in some countries under license from Bestway Inflatables & Material Corp., Shanghai, China

Exported by Bestway (Hong Kong) International Ltd./Bestway Enterprise Company Limited

Suite 713, 7/Floor, East Wing, Tsim Sha Tsui Centre, 66 Mody Road, Kowloon, Hong Kong

Distributed in North America by Bestway (USA) Inc., 3435 S. McQueen Road, Chandler, AZ 85286, United States of America

Tel: +86 21 69135588

[www.bestwayusa.com](http://www.bestwayusa.com)

**Bestway**

303021297536