

Bestway®

FLOWCLEAR™



©2022 Bestway Inflatables & Material Corp.

All rights reserved

Trademarks used in some countries under license from Bestway Inflatables & Material Corp., Shanghai, China

Exported by Bestway (Hong Kong) International Ltd./Bestway Enterprise Company Limited

Suite 713, 7/Floor, East Wing, Tsim Sha Tsui Centre, 66 Mody Road, Kowloon, Hong Kong

Distributed in North America by Bestway (USA) Inc., 3435 S. McQueen Road, Chandler, AZ 85286, United States of America

Tel: +86 21 69135588

www.bestwayusa.com



OWNER'S MANUAL

58614E Filter Pump



Visit the Bestway YouTube channel

IMPORTANT SAFETY INSTRUCTIONS

Carefully read, understand, and follow all information in this user manual before installing and using the Filter Pump. These warnings, instructions, and safety guidelines address some common risks of water filtration systems, but they cannot cover all risks and dangers in all cases. Always use caution, common sense, and good judgment when enjoying any water activity. Retain this information for future use. In addition, the following information can be supplied depending on the Filter Pump type. Keep the instructions in a safe place. If instruction is missing, search it on the website www.bestwayusa.com/support.

FCC ID: 2AS3R-BW58614

When installing and using this electrical equipment, basic safety precautions should always be followed, including the following:

READ AND FOLLOW ALL INSTRUCTIONS

WARNING - TO REDUCE THE RISK OF INJURY, do not permit children to use this product unless they are closely supervised at all times.

WARNING - RISK OF ELECTRIC SHOCK. Connect only to a grounding type receptacle. This product is provided with a ground-fault circuit-interrupter. If replacement of the plug is needed, use only identical replacement parts.

WARNING: The unit is provided with a ground-fault circuit-interrupter (**GFCI**). To test the **GFCI**, push the test button. The **GFCI** should interrupt power. Push the reset button. Power should be restored. If the **GFCI** fails to operate in this manner, the **GFCI** is defective. If the **GFCI** interrupts power to the pump without the test button being pushed, a ground current is flowing, indicating the possibility of an electric shock. Do not use this pump. Disconnect the pump and have the problem corrected by a qualified service representative before using.

CAUTION - To reduce the risk of electric shock the pool must be installed no closer than 6 feet (1.8 m) from any electrical outlet. Do not place portable appliances closer than 5 feet (1.5 m) from the pool.

WARNING: The pump is not intended to be bonded to the equipotential bonding grid. **DO NOT BURY CORD.** Locate cord to minimize abuse from lawn mowers, hedge trimmers, and other equipment.

WARNING - To reduce the risk of electric shock, replace damaged cord immediately.

WARNING - To reduce the risk of electric shock, do not use extension cord to connect unit to electric supply; provide a properly located outlet.

CAUTION - This pump is for use with storable pools only. Do not use with permanently-installed pools. A storable pool is constructed so that it is capable of being readily disassembled for storage and reassembled to its original integrity. A permanently-installed pool is constructed in or on the ground or in a building such that it cannot be readily disassembled for storage.

CAUTION - For continued protection against possible electric shock this unit is to be mounted to the base in accordance with the installation instructions.

NOTE:

- THERMALLY PROTECTED MOTOR.
- FOR USE WITH SWIMMING POOLS ONLY.

CAUTION: TO ENSURE CONTINUED PROTECTION AGAINST SHOCK HAZARD, USE ONLY IDENTICAL REPLACEMENT PARTS WHEN SERVICING.

WARNING: RISK OF ELECTRIC SHOCK. CONNECT ONLY TO A GROUNDING TYPE RECEPTACLE.

CAUTION: THIS PUMP IS FOR USE WITH STORABLE POOLS ONLY - DO NOT USE WITH PERMANENTLY-INSTALLED POOLS.

CAUTION: CONNECT ONLY TO GROUNDING TYPE RECEPTACLE PROTECTED BY A CLASS A GROUND FAULT CIRCUIT INTERRUPTER.

CAUTION: FOR CONTINUED PROTECTION AGAINST POSSIBLE ELECTRIC SHOCK THIS UNIT IS TO BE MOUNTED TO THE BASE IN ACCORDANCE WITH THE INSTALLATION INSTRUCTIONS.

WARNING - RISK OF ELECTROCUTION

- Connect Only To Properly Grounded Outlet. Do Not Remove Ground Pin
- Inspect Cord Before Using – Do Not Use If Cord Is Damaged.
- Keep Ground-Fault Circuit-Interrupter Dry And Off The Ground
- Do Not Touch Plug With Wet Hands
- Double Insulated – When Servicing Use Only Identical Replacement Parts.
- Read Instruction Manual Before Using.

DO NOT REMOVE THIS TAG

SAVE THESE INSTRUCTIONS.

This device complies with part 15 of the FCC Rules. Operation is subject to the following two conditions: (1) This device may not cause harmful interference, and (2) this device must accept any interference received, including interference that may cause undesired operation.

WARNING: Any changes or modifications to this unit not expressly approved by the party responsible for compliance could void the user's authority to operate the equipment.

NOTE: This equipment has been tested and found to comply with the limits for a Class B digital device, pursuant to part 15 of the FCC Rules. These limits are designed to provide reasonable protection against harmful interference in a residential installation. This equipment generates, uses and can radiate radio frequency energy and, if not installed and used in accordance with the instructions, may cause harmful interference to radio communications. However, there is no guarantee that interference will not occur in a particular installation. If this equipment does cause harmful interference to radio or television reception, which can be determined by turning the equipment off and on, the user is encouraged to try to correct the interference by one or more of the following measures:

- Reorient or relocate the receiving antenna.
- Increase the separation between the equipment and receiver.
- Connect the equipment into an outlet on a circuit different from that to which the receiver is connected.
- Consult the dealer or an experienced radio/ TV technician for help.

POOL SUCTION FITTING INSTRUCTIONS

When installing and using this equipment, basic safety precautions shall always be followed, including the following:

IMPORTANT SAFETY INSTRUCTIONS READ, FOLLOW, AND UNDERSTAND ALL INSTRUCTIONS AND WARNINGS.

- Any modification that increases the flow rate of the circulation system shall require re-evaluation of the cover/grate and sump to ensure that the flow rating of the Suction Outlet Fitting Assembly (SOFA) is not exceeded.
- Missing, broken, or cracked cover/grates, sumps, mud-frames, or any other SOFA component shall be replaced before bathers are allowed to use the pool.
- Loose cover/grates shall be reattached before bathers are allowed to use the pool.
- Replace suction fittings every 2 years.
- The use of adhesives or other attachment methods that prevent access to suction piping or SOFA components requiring periodic servicing is prohibited.
- Refer to the following diagram for each SOFA component part instructions:
 - Any field modification made to a SOFA not authorized by the manufacturer's installation instructions shall void the SOFA certification.
 - No modification shall be made to a SOFA structure or flow path unless the new configuration has been certified as new SOFA.
 - Cover/grates and all other SOFA components shall be replaced at or before the end of their service life and that service life begins the month and year in which a SOFA component is installed with or without water.

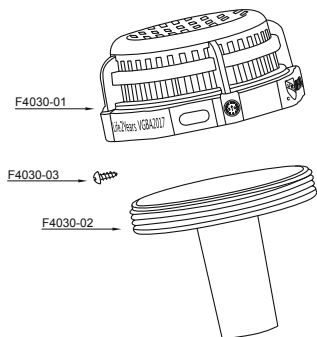

- Winterizing instructions. Dry the suction fittings completely, and store the product in a dry room at a storage temperature of 15°C ~ 40°C.
- Use the screwdriver (not included) to disassemble the suction fitting to clean or service.
- Cover/grate, including fasteners, shall be observed for damage or tampering each operational day.
- Missing, broken, or cracked cover/grates shall be replaced before bathers are allowed to use the pool.
- Loose cover/grates and associated components shall be reattached before bathers are allowed to use the pool.
- SOFA components and fastener receptacles shall be clean and free of debris or obstructions during installation of cover/grate and fasteners.
- Remember to hand-check cover/grate for snugness to the sump/ frame after installation.
- Before using the product, please check the integrity of the head of the suction fitting. If the product is broken, cracked, or the color has significantly faded, please do not use it.
- All SOFAs shall be installed in accordance with the manufacturer's installation instructions.
- No modification shall be made to a SOFA structure or flow path unless the new configuration has been certified to the original SOFA.
- These SOFA-configuration specific flow ratings NOT be exceeded at any time the pool is open to bathers.
- Cover/grates, when installed, shall not protrude more than 2 in. (51 mm) from the finished surface of the pool in which the SOFA is installed

Installation Information label (copy)

Manufacturers name:

GOLEADER INDUSTRIES (JINHUA) CO., LTD.

Cover part number: F4030

Service life of the cover: 2 Years

Cover flow rating: 28 GPM

Installer needs to fill in the balance of the information and permanently post it as near as feasible to the pump control. Keep a copy of this information with the other important pool related documents.

Configuration and installed orientation: _____

Location: _____

Installed Date: _____

Please research and download General Certificate of Conformity through www.bestwayusa.com

SAVE THESE INSTRUCTIONS

TECHNICAL SAFETY INSTRUCTIONS

- If the supply cord is damaged, it must be replaced by the manufacturer, its service agent or similarly qualified persons in order to avoid a hazard.
- Using the pump with an unmatched electrical supply is dangerous and will result in catastrophic failure of pump.
- When working with electricity, turn the electrical power off at the circuit breaker and lock breaker door. Failure to do so will result in increased risk of shock, injury and possibly death.
- Do not remove the grounding prong or modify the plug in any way. Do not use adapter plugs. Consult

- a qualified electrician for any questions related to the validity of your plug's grounding. Handle the pump with care. Do not pull or carry the pump by the power cord. Never pull a plug from the outlet by yanking the power cord. Keep cord free from abrasions. Sharp objects, oil, moving parts, and heat should never be exposed to the filter pump.
- Atmospheric conditions may affect the performance and life span of your filter pump. Unnecessary wear and tear may occur during periods of cold, heat and exposure to sun. Whenever possible shelter the pump from these conditions.
 - Do not add chemicals in the filter pump.
 - Assembly and disassembly of this product should only be performed by adults.

GFCI WARNING

- Risk of electric shock. The GFCI must be tested before each use.
- Before inserting plug into a power outlet, make sure the current rate of the power outlet is suitable for the pump.
- Do not use the pump if this test fails. For assistance, please visit the support section on our website, www.bestwayusa.com.
- To prevent the risk of electrical shock, ensure your hands are completely dry when plugging-in the Filter Pump.
- Do not dry run the filter pump. Make sure both the pool's Inlet and Outlet valves are fully covered by water before operating the Filter Pump.
- Never operate the pump while the connection valves are closed.

ATTACHING A BASE

The filter pump must be vertically fixed on the ground or a base made of wood or concrete before use. There should be two holes 7mm in diameter on the base, the space between which should be 242mm. Put filter pump on the base and attach them together by fastening the bolts and nuts. All the base parts should weigh at least over 18kg to prevent the pump from accidentally falling.

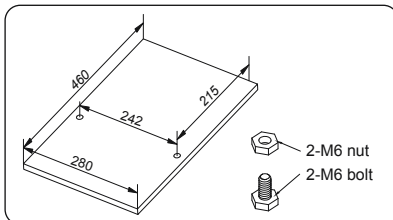

SETUP

CHECK LIST

To check the parts included in the box, consult the part list inside this manual. Verify that the equipment components represent the model that you had intended to purchase. In case of any damaged or missing parts at the time of purchase, visit our website bestwayusa.com/support.

CHOOSE THE CORRECT LOCATION

Place the Filter Pump on a solid and level ground; it must be positioned on the same level as the base of the pool. If the Filter Pump is in an upper or lower position than the base of the pool, the performance and life span of the Filter Pump can be compromised. The pool and the Filter Pump have to be positioned in an area with adequate drainage and easy access for maintenance operations. Never place the Filter Pump in an area that may accumulate water.

INSTALLATION

- For the installation instructions, refer to the illustration steps  inside the manual. Drawings are for illustration purposes only. May not reflect actual product. Not to scale.
- Bestway will not be responsible for any damage caused to the Filter Pump due to mishandling or failure to follow these instructions.
- It is imperative to check that the hydraulic connectors are not obstructed.
- Do not dry run the Filter Pump. Make sure both the pool's inlet and outlet valves are fully covered by water before operating the Filter Pump.

USING THE FILTER PUMP



On/Off button/Wi-Fi toggle

This button has two functions:

- On/off function: To start or stop the pump.
- Wi-Fi activation function: For more information, please refer to Wi-Fi operation instructions.



Time setting button

During the set-up operation, the display will flash. Every time you push the set-up button, the timer will decrease 1 hour. When you reach the desired time, don't push any buttons for 5 seconds. The display light will stop flashing. The set-up is finished.



Wi-Fi indicate light

This LED indicates the status of the Wi-Fi connection. Check the Wi-Fi Indicator Light Definitions section for the different statuses of this LED.

- After setting the run time, the pump will restart automatically at the same time the following day.
- In case of a power outage or power cord loosening, the running time of the product will be reset to a 10 hour default.



Filter cartridge status indicator / Low flow rate





Filter indicator on: The filter element is dirty, or the system has detected a low flow rate. Follow the troubleshooting instructions to reset the element.



Digital display

" - - " indicates 'Standby Status' - Press the On/Off button  to access the pump's set run timer.

Wi-Fi Indicator Light Definitions

Indicator Display	Definition
 WiFi indicator light on	Connected to the router
 WiFi indicator light off	Light damaged / Wi-Fi module has problem
 WiFi indicator flashes quickly	Lost Wi-Fi signal
 WiFi indicator flashes slowly	Waiting to connect to the router

Wi-Fi indicator only indicates the state of connection between the pump and the wireless router. When your Wi-Fi indicator lights up but the device in the app is offline, please check whether your wireless router network is malfunctioning.

MAINTENANCE

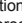
- Make sure that the Filter Pump is unplugged before any maintenance.
- For the maintenance instructions, refer to illustration steps  inside the manual. Drawings are for illustration purposes only. May not reflect actual product. Not to scale.
- To optimize the Filter Pump performance and for sanitary reasons, we suggest replacing the filter cartridge with a new one every two weeks.

STORAGE

- Remove all accessories; be sure that Filter Pump, hoses and debris screens are completely clean and dry before the storage. If all the parts are not completely dry, mold may result.
- Before storage, remove and dispose of the filter cartridge.
- We strongly recommend disassembling the Filter Pump when the environment temperature is below 50°F / 10°C.
- Store the Filter Pump in a dry place with a moderate temperature between 50°F / 10°C and 100°F / 38°C.

WARRANTY TERMS

For information concerning warranty terms, visit our website at: www.bestwayusa.com

TROUBLESHOOTING

If the detection shows "Er" or the app prompts "Filter pump detects no water flow", unplug the plug and resolve the problem according to the following solutions.

Code	Reasons	Solutions
Device displays "Er" or app prompts "Filter pump detects no water flow"	<ul style="list-style-type: none"> The system detects no water flow. The pump is on but the motor isn't running. 	<ul style="list-style-type: none"> Make sure that the inlet and outlet of the pool are fully covered by water. Make sure the inlet and outlet valves are open. Purge air from the whole circulation system. For assistance, please visit the support website www.bestwayusa.com.
The filter indicator lights up or app prompts "Filter cartridge is dirty / Low flow rate"	<ul style="list-style-type: none"> Control valve is closed or not completely open. Debris is blocking hoses / debris screen. The filter cartridge is dirty. 	<ul style="list-style-type: none"> Check and open the control valve. Remove the blockage and reset the alarm. Take out the filter cartridge and rinse it. Replace the filter element with a new one, if the error remains. For assistance, please visit the support website www.bestwayusa.com.
The app prompts "The filter pump is off and cannot be controlled"	<ul style="list-style-type: none"> This alarm will appear if the timing interface is open and the filter pump is switched off at the same time. 	<ul style="list-style-type: none"> Click "x" to close. For assistance, please visit the support website www.bestwayusa.com.
GFCI LED flashes	<ul style="list-style-type: none"> Plug may be loose in the socket; the internal metal part of the plug doesn't guarantee a secure connection. 	<ul style="list-style-type: none"> Replace the socket. Replace the pump.

Problems	Probable Causes	Solutions
The Wi-Fi setup is not successful	The pump has been connected to the wrong band	If the router your pump is connected to is dual-band and currently not connecting to a 2.4GHz network, please switch to another band of the same router (2.4GHz) and try to pair pump again. 5GHz networks are not supported.
	The filter pump location is too far from the router	Check with your cell phone to see if there is full Wi-Fi signal. In case the strength of the signal on your phone is too low, check where the strength of the Wi-Fi signal is full and place the filter pump in that position.
	Set up the wrong Network Name	Start the connection procedures again and be sure that the network name is typed correctly.
	The Wi-Fi password used during the connection is wrong	Start the connection procedures again and be sure that the password is correct.
	The strength of the Wi-Fi signal is not stable	<ol style="list-style-type: none"> Check if the router works correctly. Go near the filter pump and check the signal on your phone. In case the signal strength is not stable, check the condition of your router. In case the signal strength is full, repeat the operation to connect the filter pump to the network.
	There is an appliance near the filter pump or the router that creates Signal Interference	The Wi-Fi connectivity can be interrupted by electromagnetic or other interferences. Keep the appliance away from other electronic devices that may cause interferences.
	Your phone will not connect to the Wi-Fi network during the registration	Check if the mobile device is in airplane mode. Make sure to have the airplane mode deactivated when connecting to the Wi-Fi network.
	APP Feedback	Consult the help section in the APP for extensive and up-to-date troubleshooting tips.



	V1	V2
1	x1	x1
2	x1	x1
3	x1	x1
4	x1	x1
5	x1	x1
6	x3	x3
7	x2	x2
8	x2	x2
9	x0	x2
10	x4	x5
11	x1	x1
12	x2	x2
13	x2	x2
14	x0	x1



V1

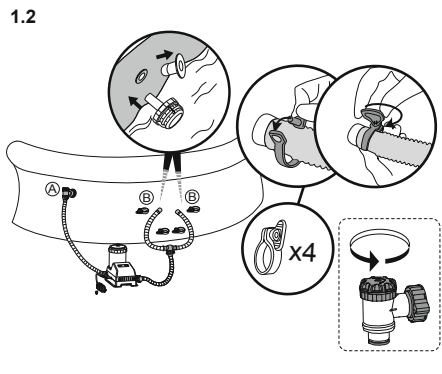
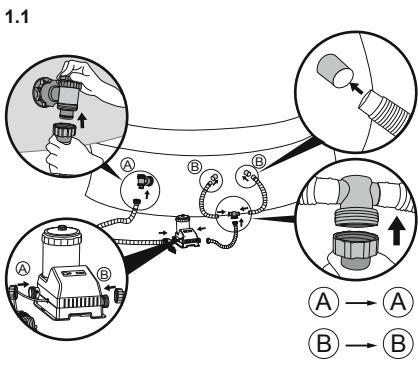

1.3

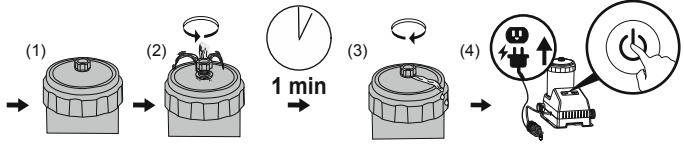
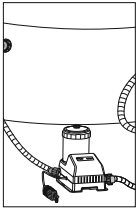

V2

2.1

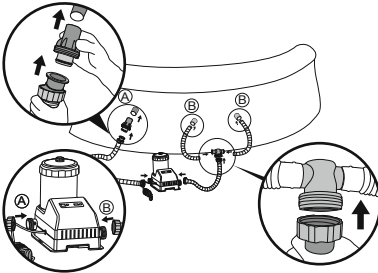

2.2

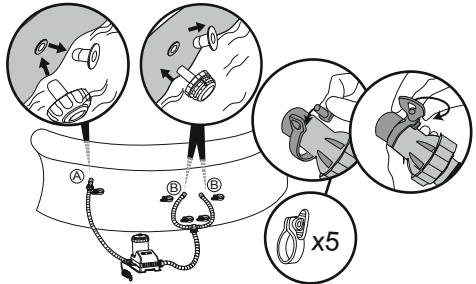

2.3

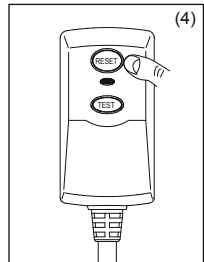
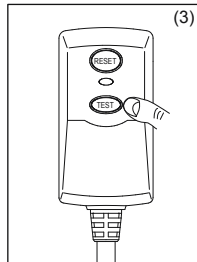
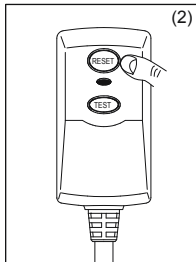
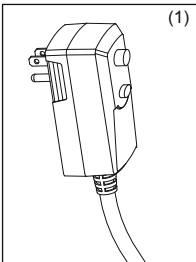
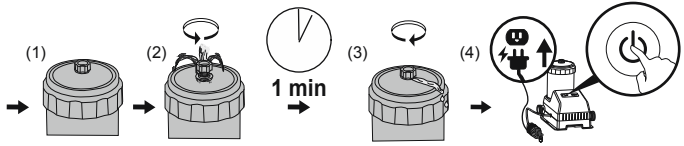
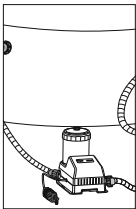



V1

1.1

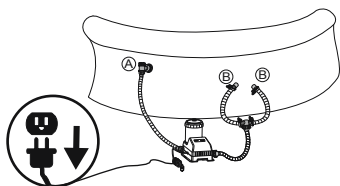

1.2

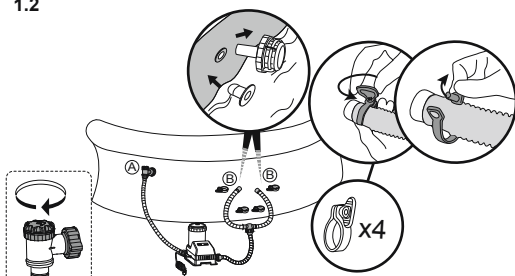

1.3

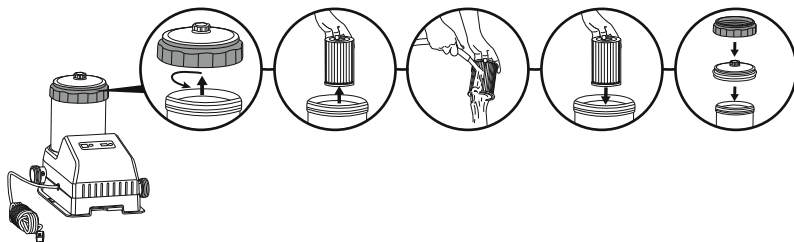

1.4

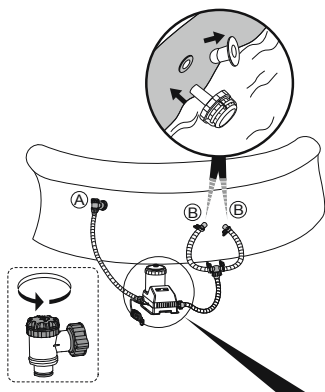

(1)



(2)



1 min

(3)

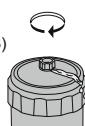

(4)

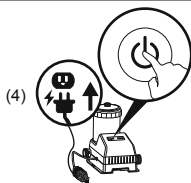



V2

2.1

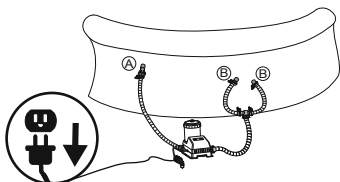

2.2

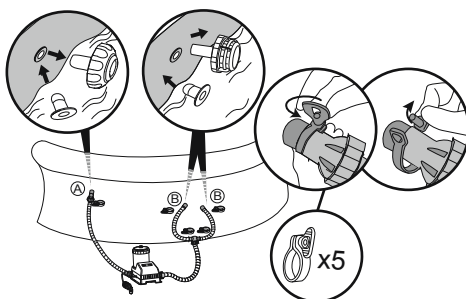

2.3

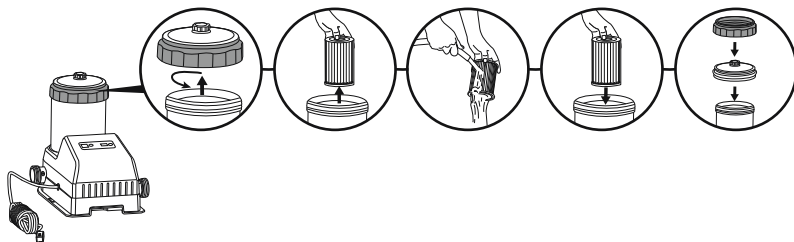

2.4

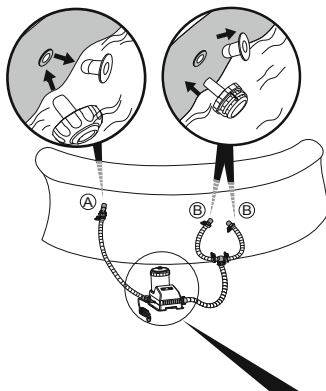

(1)



(2)



1 min

(3)

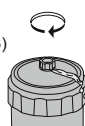

(4)

