

# OWNER'S MANUAL

PLEASE READ THESE INSTRUCTIONS CAREFULLY BEFORE USING THIS PRODUCT.

**⚠ WARNING:** Adult assembly required.

**WARNING:** Before using this product, ensure that it is placed on completely level ground and filled to capacity with water. Failure to do so may result in the product rolling downslope and entrapping the user in the product, which may result in injury.

- Maximum Weight Capacity: 441 lbs / 200 kg. Exceeding this limit may result in damage to product or injury.

## CLEANING AND MAINTENANCE

1. When done using the product, open the water valve and drain the product of all water until empty.
2. Once product is drained completely, take a damp cloth to gently clean all surfaces.

**NOTE:** Never use solvents or other chemicals as they may damage the product.

3. Store in a cool, dry place and out of children's reach.
4. Check the product for damage at the beginning of each season and at regular intervals when in use.

## REPAIR

If a chamber is damaged use the provided repair patch to fix it.

1. Completely drain the product.
2. Clean and dry the damaged area.
3. Apply the provided repair patch and smooth out any air bubbles.

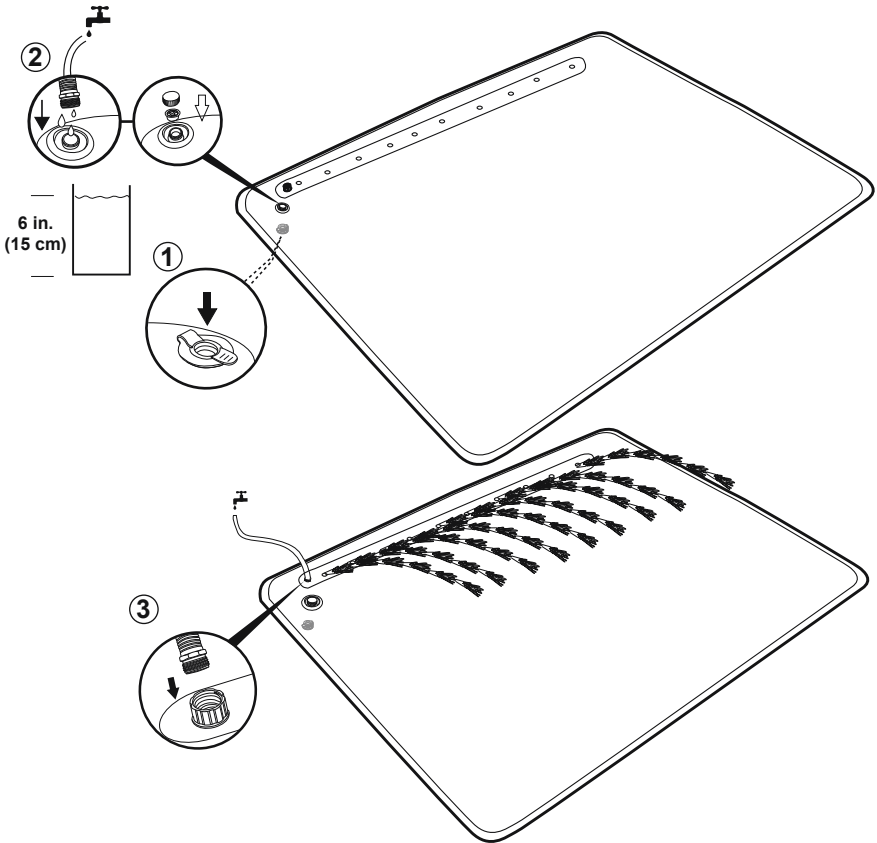

# Bestway®

©2022 Bestway Inflatables & Material Corp.

All rights reserved

Trademarks used in some countries under license from **Bestway Inflatables & Material Corp., Shanghai, China**

Exported by **Bestway (Hong Kong) International Ltd./Bestway Enterprise Company Limited**

**Suite 713, 7/Floor, East Wing, Tsim Sha Tsui Centre, 66 Mody Road, Kowloon, Hong Kong**

Distributed in North America by **Bestway (USA) Inc., 3435 S. McQueen Road, Chandler, AZ 85286, United States of America**

Tel: +86 21 69135588

[www.bestwayusa.com](http://www.bestwayusa.com)